

TYPICAL ATRA ANCHOR SYSTEM

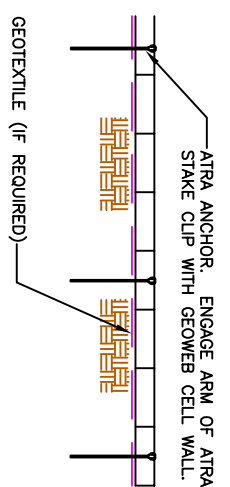

SECTION A - A

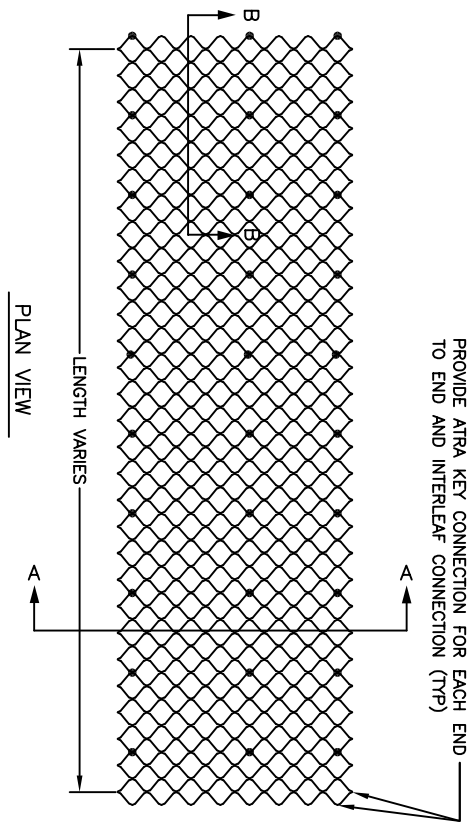
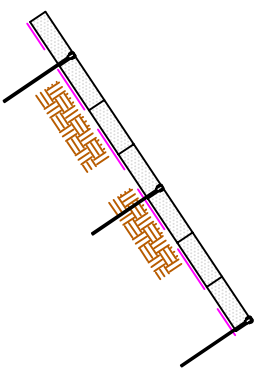

SECTION B - B

- NOTES:
1. ATRA ANCHORS SHALL CONSIST OF NO. 4 REBAR WITH AN ATRA STAKE CLIP INSERTED INTO THE END OF THE REBAR. LENGTH OF THE ATRA ANCHORS SHALL BE AS SPECIFIED.
  2. PRE-ASSEMBLED ATRA GFRP (POLYMER) ARE AVAILABLE FROM PRESTO GEOSYSTEMS.
  3. THE GEOWEB CELLS SHALL BE FILLED WITH THE SPECIFIED MATERIAL (TOPSOIL, STONE, OR CONCRETE) AND SHALL BE SUITABLE TO WITHSTAND THE APPLICABLE HYDRAULIC CONDITIONS.
  4. THE GEOWEB SECTIONS SHALL BE ANCHORED TO RESIST SLIDING DUE TO DRIVING AND HYDRAULIC FORCES.
  5. IF VEGETATION IS DESIRED, PROVIDE AN EROSION CONTROL BLANKET OR TURF REINFORCEMENT MAT IF THERE IS A POTENTIAL FOR EROSION PRIOR TO ESTABLISHING VEGETATION.
  6. THE GEOWEB PANELS SHALL BE CONNECTED WITH ATRA KEYS AT EACH INTERLEAF AND END TO END CONNECTION.
  7. REFER TO THE GENERAL DETAIL DRAWINGS FOR ANCHOR DETAILS.

STAKE ANCHOR INSTALLATION

- STEPS:
1. POSITION THE ATRA ANCHOR NEXT TO THE UP-SLOPE CELL WALL.
  2. DRIVE ATRA ANCHOR INTO THE GROUND UNTIL ARM OF ATRA ANCHOR IS LOCATED ABOVE GEOWEB CELL WALL.
  3. ENGAGE ARM OF ATRA ANCHOR TO CELL WALL AND DRIVE UNTIL TIGHT.

ATRA ANCHOR DETAIL

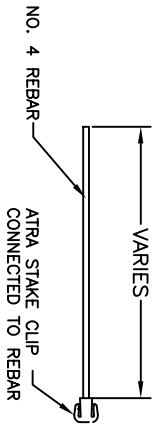

THIS DRAWING IS COPYRIGHTED AND BASED UPON THE USE OF GENUINE GEOWEB MANUFACTURED BY PRESTO GEOSYSTEMS. ANY USE OF THIS DRAWING FOR ANY PRODUCT OTHER THAN THAT MANUFACTURED BY PRESTO GEOSYSTEMS IS STRICTLY PROHIBITED.

PRESTO® PRODUCTS CO.  
670 NORTH PERKINS STREET  
CENOS, ILLINOIS 62506  
WWW.PRESTOGEOSYSTEMS.COM

GENUINE GEOWEB®  
SLOPE WITH ATRA ANCHORS

PRESTO, GEOWEB, AND ATRA ARE REGISTERED TRADEMARKS OF PRESTO PRODUCTS.  
DATE: NOVEMBER 2019  
FILE NAME: QMS11FDWG  
SCALE: NTS  
SHEET: 1  
© 2010 PRESTO GEOSYSTEMS