

DOOR NUMBER	QTY	OPENING		ACTUAL		MODEL	JAMB			MOUNTING		LOCK	PANELS WIDE	PANELS HIGH	SECTION NUMBER OPEN FOR GLASS								JOB:	DISTR:	CONTR:	ARCH:	NR:2904934								
		WIDTH	HEIGHT	WIDTH	HEIGHT		W	S	M	ANGLE	BRKT				1	2	3	4	5	6	7	8													

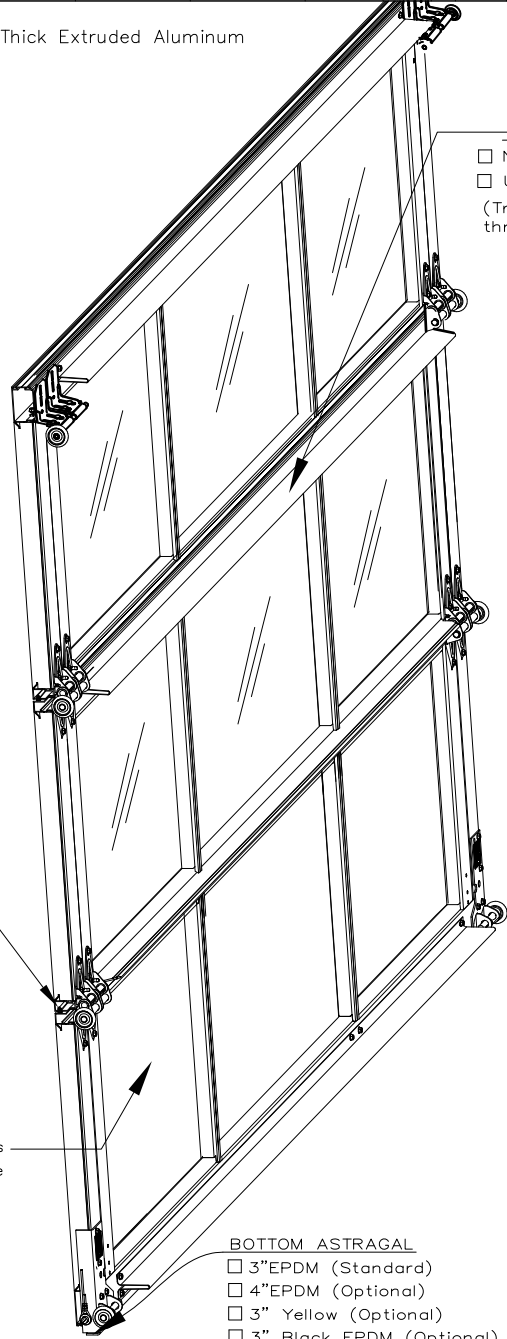

AlumaView – AV175, 1–3/4” Thick Extruded Aluminum

- COLOR
- Clear Anodized
  - Champagne Anodized
  - Light Bronze Anodized
  - Medium Bronze Anodized
  - Dark Bronze Anodized
  - Extra Dark Bronze Anodized
  - Black Anodized
  - ArmorBrite Powdercoat  
187 Custom Colors  
(Av300 and Av200 Only)



- TRUSSING
- None
  - Ubar (18 or 20 Gauge)  
(Trussing May show through Glazing)

Thermal Break

- .50 Thick Aluminum Panels
- 3/8” Expanded Polystyrene Insulation(Panels Only)

- BOTTOM ASTRAGAL
- 3”EPDM (Standard)
  - 4”EPDM (Optional)
  - 3” Yellow (Optional)
  - 3” Black EPDM (Optional)

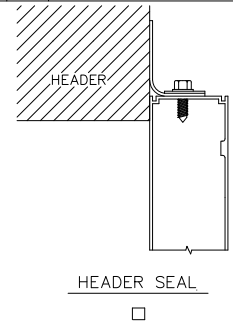

- GLASS (CLEAR)\_\_\_\_\_ (DSB 3/16”(4.8MM) OR DSB 1/4” (6.4MM))
- GLASS (WIRE)\_\_\_\_\_ (DSB 3/16”(4.8MM) OR DSB 1/4” (6.4MM))
- GLASS (TEMPERED)\_\_\_\_\_ (1/8”(3.2MM), 3/16”(4.8MM) OR 1/4” (6.4MM))
- PLEXIGLASS\_\_\_\_\_ (1/8”(3.2MM) OR 1/4” (6.4MM))
- LEXAN\_\_\_\_\_ (1/8”(3.2MM) OR 1/4” (6.4MM))

- LOCKING – CREMONE TYPE BOLT ENGAGES SLOT IN TRACK, \_\_\_\_\_ HAND SIDE. FIVE PIN TUMBLER CYLINDER OUTSIDE – NIGHT LATCH INSIDE.
  - LOCKING – SPRING LOADED SLIDE BOLT ENGAGES SLOT IN TRACK. OPERABLE FROM INSIDE ONLY – MAY BE MOUNTED EITHER SIDE
  - LOCKING – OMIT LOCK.
- LOCKS SHOULD NOT BE SUPPLIED WITH AN ELECTRIC OPERATED DOOR WITHOUT A LOCK INTERLOCK SWITCH.

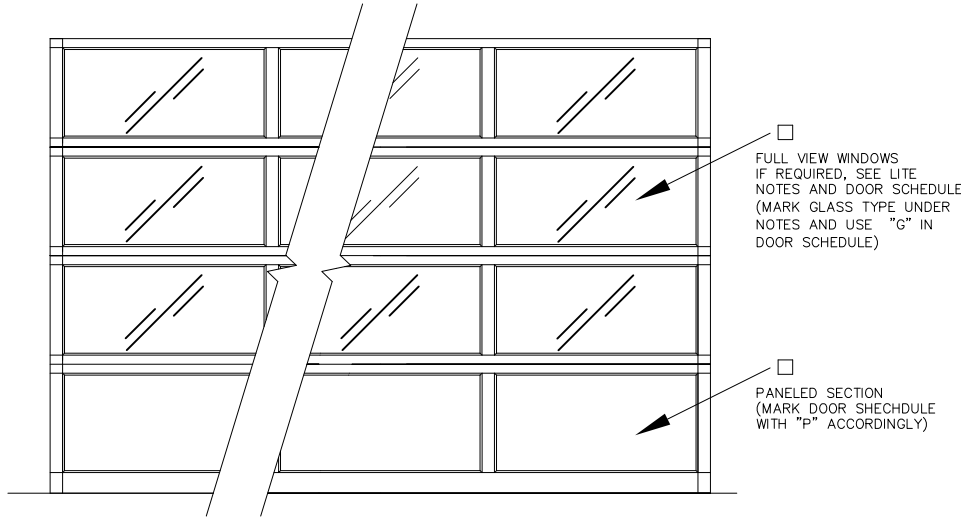

FULL VIEW WINDOWS IF REQUIRED, SEE LITE NOTES AND DOOR SCHEDULE (MARK GLASS TYPE UNDER NOTES AND USE "G" IN DOOR SCHEDULE)

PANELED SECTION (MARK DOOR SHECHDULE WITH "P" ACCORDINGLY)

INTERIOR ELEVATION

DOOR NUMBER	QTY	OPENING		ACTUAL		MODEL	JAMB		MOUNTING		LOCK	PANELS WIDE	PANELS HIGH	SECTION NUMBER OPEN FOR GLASS								JOB: DISTR: CONTR: ARCH: NR:2904934		
		WIDTH	HEIGHT	WIDTH	HEIGHT		W	S	M	ANGLE				BRKT	1	2	3	4	5	6	7		8	



### Commercial Doors

Door Model	Section Width	U-bar 20 Ga. (.82#/ft)	U-bar 18 Ga. (1.15#/ft)	Special Bottom Truss	20 g Box Strut (1.78 #/ft)	4" Rigid Truss (1.65#/ft)	6" Rigid Truss (1.65#/ft)	18 g Box Strut (2.45 #/ft)	8" Rigid Truss (2.4#/ft)	Special 8" Rigid Truss (2.6#/ft)	Special Notes
AlumaView	AV175 (Standard)	12'-3" thru 14'-2"		1 Top Section (Note 11)							
		w/ glass over 2#/ft <sup>2</sup>		1 Top Section (Note 11)	1 Bottom Section (Note 12)						

TABLE #1  
PANEL CHART

PANEL CHART	
QUANTITY OF PANELS	MAXIMUM SECTION WIDTH
1	5' - 2-1/8"
2	9' - 2-1/8"
3	12' - 2-1/8"
4	16' - 2-1/8"

### Product Specific Notes

- 11. Top section u-bar length = Section width - 13".
- 12. Bottom section u-bar length = Section width - 13".
- 17. Glass over 2 #/sq. ft. includes:  
3CLR, 4CLR, 3TEM, 4TEM, 4CWG, 4LAM, 4TN, 4TNTP