

DOOR NUMBER	QTY	OPENING		ACTUAL		MODEL	JAMB				MOUNTING ANGLE	LOCK	PANELS WIDE	PANELS HIGH	SECTION NUMBER OPEN FOR GLASS								JOB:	DISTR:	CONTR:	ARCH:	NR:2904935									
		WIDTH	HEIGHT	WIDTH	HEIGHT		W	S	M	1					2	3	4	5	6	7	8															

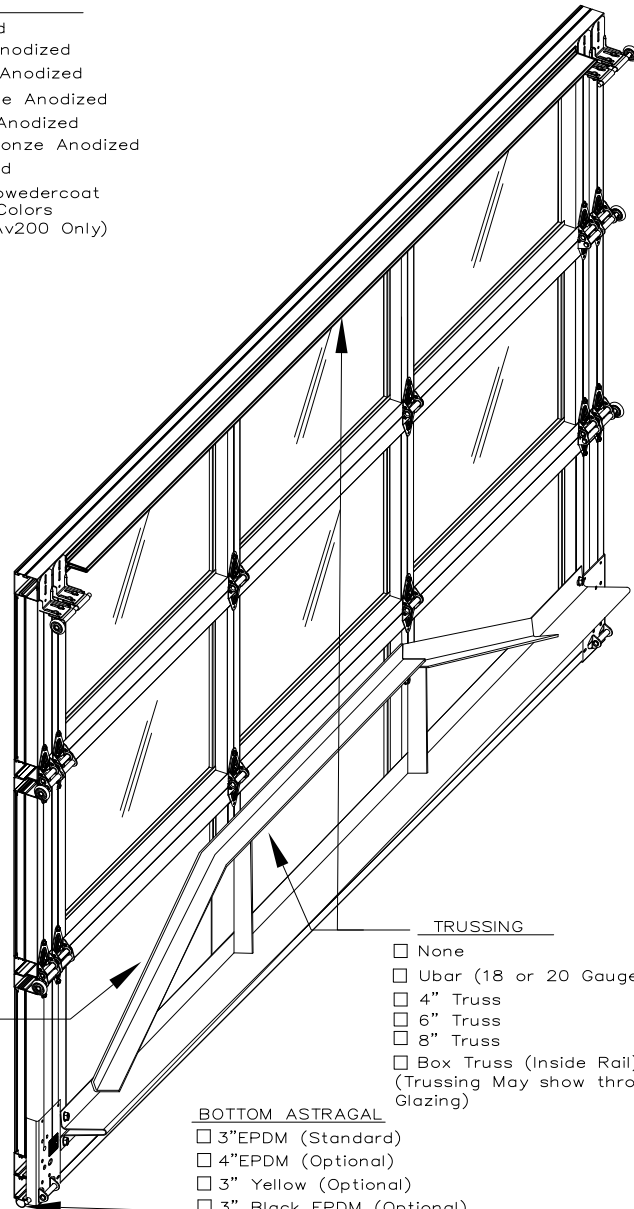

AlumaView – AV300, 3” Thick Extruded Aluminum

- COLOR
- Clear Anodized
 - Champagne Anodized
 - Light Bronze Anodized
 - Medium Bronze Anodized
 - Dark Bronze Anodized
 - Extra Dark Bronze Anodized
 - Black Anodized
 - ArmorBrite Powdercoat 187 Custom Colors (Av300 and Av200 Only)



- .50 Thick Aluminum Panels
- 3/8” Expanded Polystyrene Insulation(Panels Only)

- TRUSSING
- None
 - Ubar (18 or 20 Gauge)
 - 4” Truss
 - 6” Truss
 - 8” Truss
 - Box Truss (Inside Rail) (Trussing May show through Glazing)

- BOTTOM ASTRAGAL
- 3” EPDM (Standard)
 - 4” EPDM (Optional)
 - 3” Yellow (Optional)
 - 3” Black EPDM (Optional)

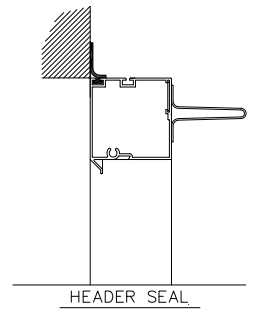

- GLASS (CLEAR)_____ (DSB 3/16”(4.8MM) OR DSB 1/4” (6.4MM))
 - GLASS (WIRE)_____ (DSB 3/16”(4.8MM) OR DSB 1/4” (6.4MM))
 - GLASS (TEMPERED)_____ (1/8”(3.2MM), 3/16”(4.8MM) OR 1/4” (6.4MM))
 - PLEXIGLASS_____ (1/8”(3.2MM) OR 1/4” (6.4MM))
 - LEXAN_____ (1/8”(3.2MM) OR 1/4” (6.4MM))

 - LOCKING – CREMONE TYPE BOLT ENGAGES SLOT IN TRACK, _____ HAND SIDE. FIVE PIN TUMBLER CYLINDER OUTSIDE – NIGHT LATCH INSIDE.
 - LOCKING – SPRING LOADED SLIDE BOLT ENGAGES SLOT IN TRACK. OPERABLE FROM INSIDE ONLY – MAY BE MOUNTED EITHER SIDE
 - LOCKING – OMIT LOCK.
- LOCKS SHOULD NOT BE SUPPLIED WITH AN ELECTRIC OPERATED DOOR WITHOUT A LOCK INTERLOCK SWITCH.

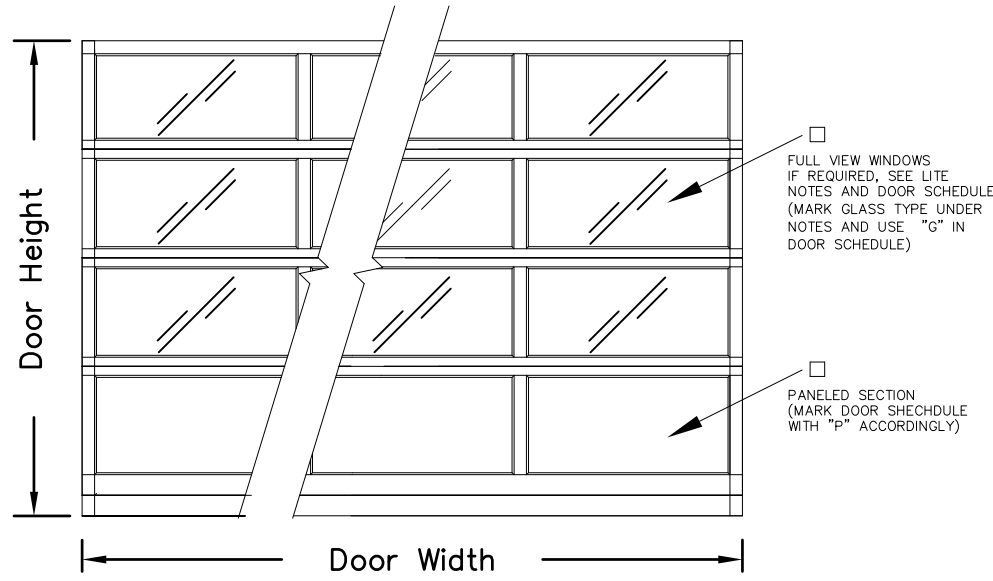



DOOR NUMBER	QTY	OPENING		ACTUAL		MODEL	JAMB			MOUNTING		LOCK	PANELS WIDE	PANELS HIGH	SECTION NUMBER OPEN FOR GLASS								JOB:			
		WIDTH	HEIGHT	WIDTH	HEIGHT		W	S	M	ANGLE	BRKT				1	2	3	4	5	6	7	8		DISTR:		
																										DISTR:
																										CONTR:
																										ARCH: NR:2904935

Alumaview Optima

Door Model	Section Width	U-bar 20 Ga. (.82#/ft)	U-bar 18 Ga. (1.15#/ft)	Special Bottom Truss	20 g Box Strut (1.78 #/ft)	4" Rigid Truss (1.65#/ft)	6" Rigid Truss (1.65#/ft)	18 g Box Strut (2.45 #/ft)	8" Rigid Truss (2.4#/ft)	Special 8" Rigid Truss (2.6#/ft)	Special Notes
AlumaView	AV300	18'-3" thru 22'-2"	1 per Section (Note 12,13,19)								
		22'-3" thru 24'-2"		1 per Section (Note 12, 13, 19)	1 Bottom Section (Note 12)						

TABLE #1
PANEL CHART

PANEL CHART	
QUANTITY OF PANELS	MAXIMUM SECTION WIDTH
1	5' - 2-1/8"
2	9' - 2-1/8"
3	12' - 2-1/8"
4	16' - 2-1/8"
5	20' - 2-1/8"
6	24' - 2-1/8"
7	28' - 2-1/8"
8	32' - 2-1/8"
9	36' - 2-1/8"
10	40' - 2-1/8"

Product Specific Notes

- Bottom section u-bar length = Section width - 13".
- Top section u-bar length = Section width -14".
- Doors with an even number of sections requires a u-bar on the top section.
- Glass over 2 #/sq. ft. includes:
3CLR, 4CLR, 3TEM, 4TEM, 4CWG, 4LAM, 4TN, 4TNTP
- U-bars for intermediate sections to be factory installed inside the aluminum rails. Top u-bar and bottom u-bar/sag truss to be field Installed