

2c

RFPI®-JOISTS ABOVE RIDGE SUPPORT BEAM

$\frac{3}{4}$ " x 2'-0" plywood gusset (face grain horizontal) each side with (12) 8d nails clinched.

-OR- Simpson LSTA21 strap* with (16) 10d x 1½" nails

*** Strap required for members with slope greater than 3/12.**

Double beveled wood plate

RIGIDLAM® LVL support beam

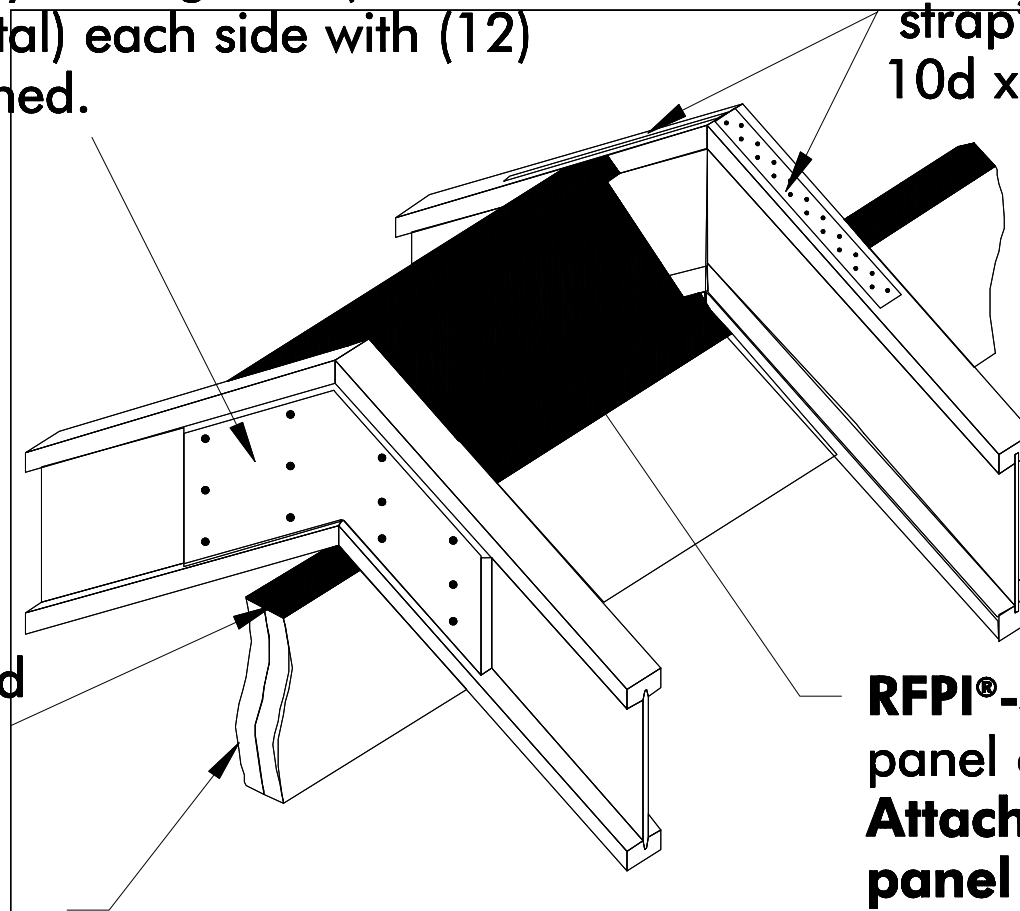

RFPI®-Joist blocking panel or x-bracing. Attach blocking panel (or Rimboard) to top plate with 8d nails @ 6" o.c. (when used for lateral shear transfer, nail to bearing plate with same nailing as required for decking)

Uplift connections may be required.