

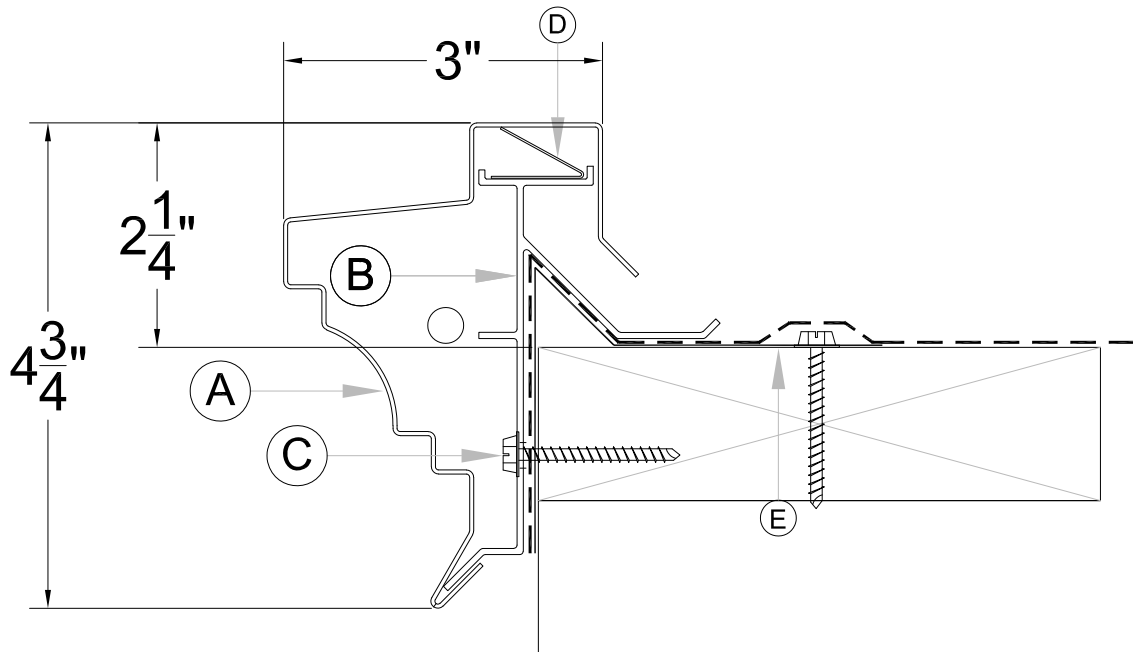

SUBMITTAL / DATA SHEET

Designer Series Press-Loc Gravel Stop
Eclectic Collection

4 $\frac{1}{2}$ " Model PLGS.EC1-4



Legend:

- A: Snap-on Fascia, 10' lengths. Joint treatment consists of a $\frac{3}{8}$ " expansion reveal and 4" wide concealed splice plate.
B: Extruded Aluminum Secure Bar, 10' Length
C: #12 x 1.5" S.S. Wood Screws @ 12" centers
D: Stainless Steel Tension Clips @ 24" centers
E: Metal Edging by Installer

Material Options

Metal	Coping
Aluminum	
0.040	<input type="checkbox"/>
0.050	<input type="checkbox"/>
0.063	<input type="checkbox"/>
0.080	<input type="checkbox"/>
0.090	<input type="checkbox"/>
0.125	
0.1875	
0.250	
Copper	
16 oz	<input type="checkbox"/>
20 oz	<input type="checkbox"/>
32 oz	<input type="checkbox"/>

Finish Options

Finish	Coping
EZ Mix Kynar	<input type="checkbox"/>
Custom Kynar	<input type="checkbox"/>
Anodized	<input type="checkbox"/>
Mill Finish	<input type="checkbox"/>

Same tested design as PLGS-6.0 and PLGS-8.0 which meets ANSI/SPRI/FM 4435/ES-1 and RE-2 Standard Requirements . Testing not required

Designer Series Press-Loc Gravel Stop, Model PLGS.EC1-4: Press-Loc is designed to accommodate the rigid performance criteria of today's advanced roofing systems. It doesn't matter if your roof membrane is E.P.D.M., Thermoplastic, Modified Bitumen, or a Built-up Roof, Press-Loc fits them all. Press-Loc allows you to install your metal edging to be flashed in accordance with your membrane manufacturer's specifications. The Secure Bar profile fully encapsulates your membrane ensuring a watertight and leakproof edge. Press-Loc's unique and simple design make installation fast and economical, while giving you a leak-proof gravel stop edge that is extremely resistant to wind uplift.

(Other Materials are Available upon Request)

(Default Selections are **BOLD**)

Customer:

Project:

Address:

Location:

Phone / Fax:

Architect:



SUBMITTAL / DATA SHEET

Designer Series Press-Loc Gravel Stop
Eclectic Collection
6" Model PLGS.EC1-6

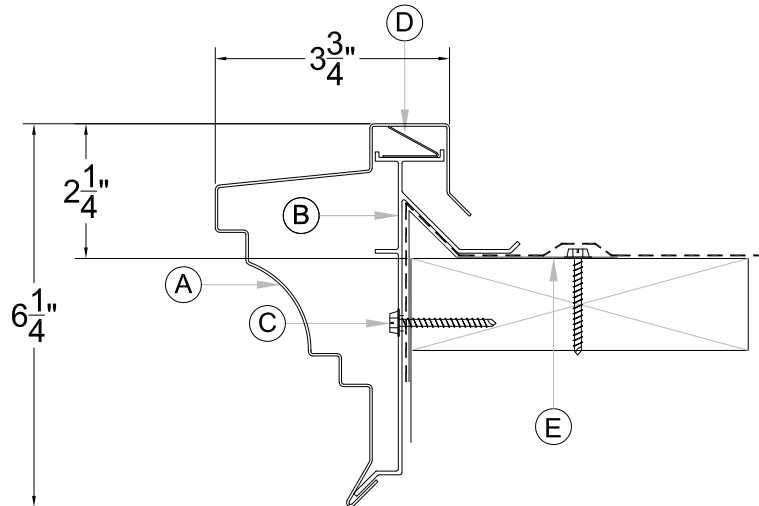

Legend:

- A: Snap-on Decorative Fascia, 10' lengths. Joint treatment consists of a $\frac{3}{8}$ " expansion reveal and 4" wide concealed splice plate.
B: Extruded Aluminum Secure Bar, 10' Length
C: #12 x 1.5" S.S. Wood Screws @ 12" centers
D: Stainless Steel Tension Clips @ 24" centers
E: Metal Edging by Installer

Material Options

Metal	Coping
Aluminum	
0.040	<input type="checkbox"/>
0.050	<input type="checkbox"/>
0.063	<input type="checkbox"/>
0.080	<input type="checkbox"/>
0.090	<input type="checkbox"/>
0.125	
0.1875	
0.250	
Copper	
16 oz	<input type="checkbox"/>
20 oz	<input type="checkbox"/>
32 oz	<input type="checkbox"/>

Finish Options

Finish	Coping
EZ Mix Kynar	<input type="checkbox"/>
Custom Kynar	<input type="checkbox"/>
Anodized	<input type="checkbox"/>
Mill Finish	<input type="checkbox"/>

**Similar to the Standard Press-Loc Gravel Stop
Model PLGS-6.0 tested to meet
ANSI/SPRI/FM 4435/ES-1 and RE-2
Standard Requirements**

Designer Series Press-Loc Gravel Stop, Model PLGS.EC1-6: Press-Loc is designed to accommodate the rigid performance criteria of today's advanced roofing systems. It doesn't matter if your roof membrane is E.P.D.M., Thermoplastic, Modified Bitumen, or a Built-up Roof, Press-Loc fits them all. Press-Loc allows you to install your metal edging to be flashed in accordance with your membrane manufacturer's specifications. The Secure Bar profile fully encapsulates your membrane ensuring a watertight and leakproof edge. Press-Loc's unique and simple design make installation fast and economical, while giving you a leak-proof gravel stop edge that is extremely resistant to wind uplift.

(Other Materials are Available upon Request)

(Default Selections are **BOLD**)

Customer:

Project:

Address:

Location:

Phone / Fax:

Architect:



SUBMITTAL / DATA SHEET

Designer Series Press-Loc Gravel Stop
Eclectic Collection
8" Model PLGS.EC1-8

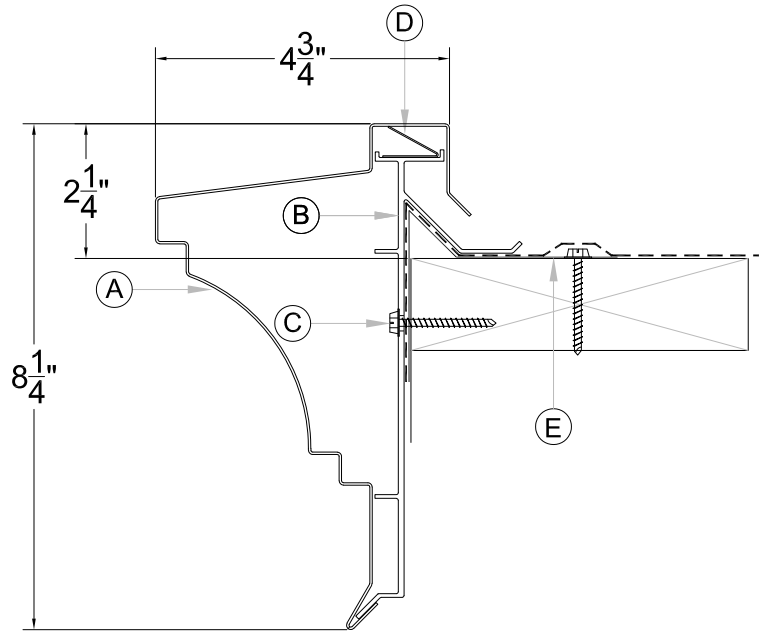

Legend:

- A: Snap-on Decorative Fascia, 10' lengths. Joint treatment consists of a $\frac{3}{8}$ " expansion reveal and 4" wide concealed splice plate.
B: Extruded Aluminum Secure Bar, 10' Length
C: #12 x 1.5" S.S. Wood Screws @ 12" centers
D: Stainless Steel Tension Clips @ 24" centers
E: Metal Edging by Installer

Material Options

Metal	Coping
Aluminum	
0.040	<input type="checkbox"/>
0.050	<input type="checkbox"/>
0.063	<input type="checkbox"/>
0.080	<input type="checkbox"/>
0.090	<input type="checkbox"/>
0.125	
0.1875	
0.250	
Copper	
16 oz	<input type="checkbox"/>
20 oz	<input type="checkbox"/>
32 oz	<input type="checkbox"/>

(Other Materials are Available upon Request)

Finish Options

Finish	Coping
EZ Mix Kynar	<input type="checkbox"/>
Custom Kynar	<input type="checkbox"/>
Anodized	<input type="checkbox"/>
Mill Finish	<input type="checkbox"/>

**Similar to the Standard Press-Loc Gravel Stop
Model PLGS-8.0 tested to meet
ANSI/SPRI/FM 4435/ES-1 and RE-2
Standard Requirements**

Designer Series Press-Loc Gravel Stop, Model PLGS.EC1-8: Press-Loc is designed to accommodate the rigid performance criteria of today's advanced roofing systems. It doesn't matter if your roof membrane is E.P.D.M., Thermoplastic, Modified Bitumen, or a Built-up Roof, Press-Loc fits them all. Press-Loc allows you to install your metal edging to be flashed in accordance with your membrane manufacturer's specifications. The Secure Bar profile fully encapsulates your membrane ensuring a watertight and leakproof edge. Press-Loc's unique and simple design make installation fast and economical, while giving you a leak-proof gravel stop edge that is extremely resistant to wind uplift.

(Default Selections are **BOLD**)

Customer:

Project:

Address:

Location:

Phone / Fax:

Architect:



SUBMITTAL / DATA SHEET

Designer Series Press-Loc Gravel Stop
Eclectic Collection

4 $\frac{1}{2}$ " Model PLGS.EC2-4

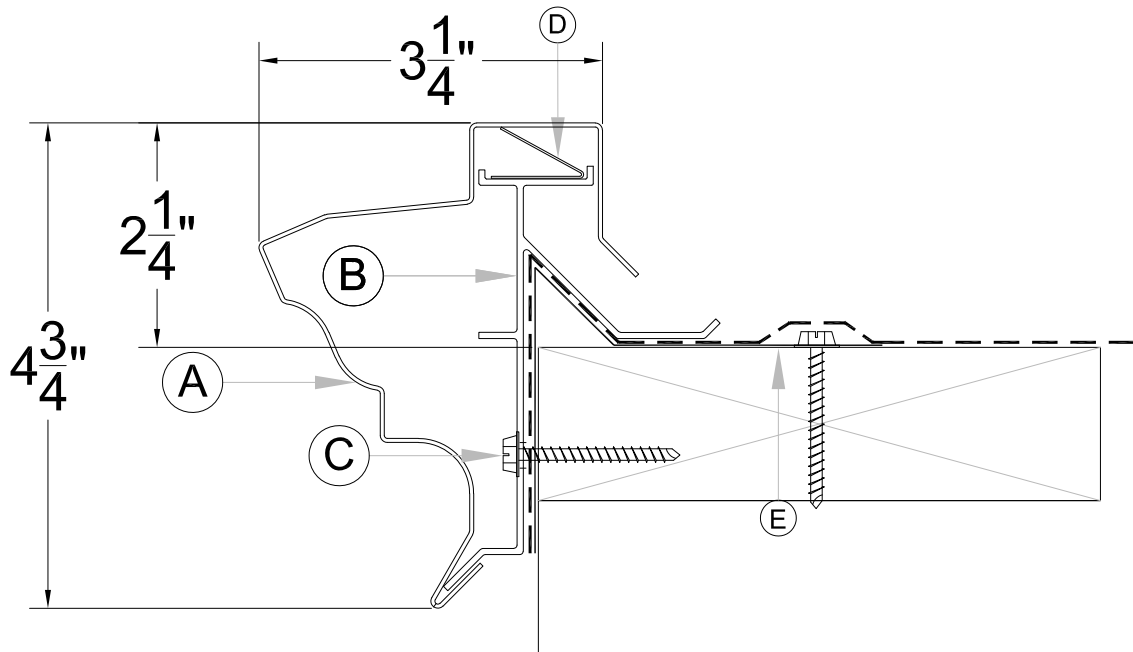

Legend:

- A: Snap-on Fascia, 10' lengths. Joint treatment consists of a $\frac{3}{8}$ " expansion reveal and 4" wide concealed splice plate.
B: Extruded Aluminum Secure Bar, 10' Length
C: #12 x 1.5" S.S. Wood Screws @ 12" centers
D: Stainless Steel Tension Clips @ 24" centers
E: Metal Edging by Installer

Material Options

Metal	Coping
Aluminum	
0.040	<input type="checkbox"/>
0.050	<input type="checkbox"/>
0.063	<input type="checkbox"/>
0.080	<input type="checkbox"/>
0.090	<input type="checkbox"/>
0.125	
0.1875	
0.250	
Copper	
16 oz	<input type="checkbox"/>
20 oz	<input type="checkbox"/>
32 oz	<input type="checkbox"/>

Finish Options

Finish	Coping
EZ Mix Kynar	<input type="checkbox"/>
Custom Kynar	<input type="checkbox"/>
Anodized	<input type="checkbox"/>
Mill Finish	<input type="checkbox"/>

**Same tested design as PLGS-6.0 and PLGS-8.0
which meets ANSI/SPRI/FM 4435/ES-1 and RE-2
Standard Requirements . Testing not required**

Designer Series Press-Loc Gravel Stop, Model PLGS.EC2-4: Press-Loc is designed to accommodate the rigid performance criteria of today's advanced roofing systems. It doesn't matter if your roof membrane is E.P.D.M., Thermoplastic, Modified Bitumen, or a Built-up Roof, Press-Loc fits them all. Press-Loc allows you to install your metal edging to be flashed in accordance with your membrane manufacturer's specifications. The Secure Bar profile fully encapsulates your membrane ensuring a watertight and leakproof edge. Press-Loc's unique and simple design make installation fast and economical, while giving you a leak-proof gravel stop edge that is extremely resistant to wind uplift.

(Other Materials are Available upon Request)

(Default Selections are **BOLD**)

Customer:

Project:

Address:

Location:

Phone / Fax:

Architect:



SUBMITTAL / DATA SHEET

Designer Series Press-Loc Gravel Stop
Eclectic Collection
6" Model PLGS.EC2-6

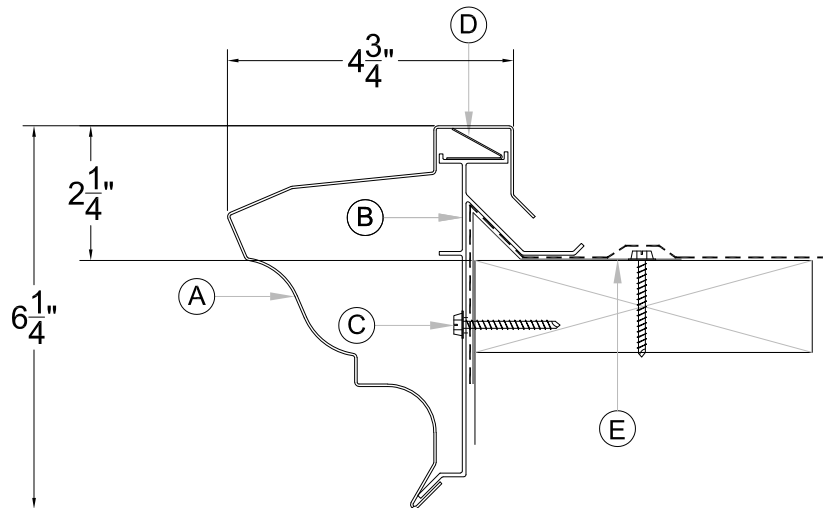

Legend:

- A: Snap-on Decorative Fascia, 10' lengths. Joint treatment consists of a $\frac{3}{8}$ " expansion reveal and 4" wide concealed splice plate.
B: Extruded Aluminum Secure Bar, 10' Length
C: #12 x 1.5" S.S. Wood Screws @ 12" centers
D: Stainless Steel Tension Clips @ 24" centers
E: Metal Edging by Installer

Material Options

Metal	Coping
Aluminum	
0.040	<input type="checkbox"/>
0.050	<input type="checkbox"/>
0.063	<input type="checkbox"/>
0.080	<input type="checkbox"/>
0.090	<input type="checkbox"/>
0.125	
0.1875	
0.250	
Copper	
16 oz	<input type="checkbox"/>
20 oz	<input type="checkbox"/>
32 oz	<input type="checkbox"/>

(Other Materials are Available upon Request)

Finish Options

Finish	Coping
EZ Mix Kynar	<input type="checkbox"/>
Custom Kynar	<input type="checkbox"/>
Anodized	<input type="checkbox"/>
Mill Finish	<input type="checkbox"/>

**Similar to the Standard Press-Loc Gravel Stop
Model PLGS-6.0 tested to meet
ANSI/SPRI/FM 4435/ES-1 and RE-2
Standard Requirements**

Designer Series Press-Loc Gravel Stop, Model PLGS.EC2-6: Press-Loc is designed to accommodate the rigid performance criteria of today's advanced roofing systems. It doesn't matter if your roof membrane is E.P.D.M., Thermoplastic, Modified Bitumen, or a Built-up Roof, Press-Loc fits them all. Press-Loc allows you to install your metal edging to be flashed in accordance with your membrane manufacturer's specifications. The Secure Bar profile fully encapsulates your membrane ensuring a watertight and leakproof edge. Press-Loc's unique and simple design make installation fast and economical, while giving you a leak-proof gravel stop edge that is extremely resistant to wind uplift.

(Default Selections are **BOLD**)

Customer:

Project:

Address:

Location:

Phone / Fax:

Architect:



SUBMITTAL / DATA SHEET

Designer Series Press-Loc Gravel Stop
Eclectic Collection
8" Model PLGS.EC2-8

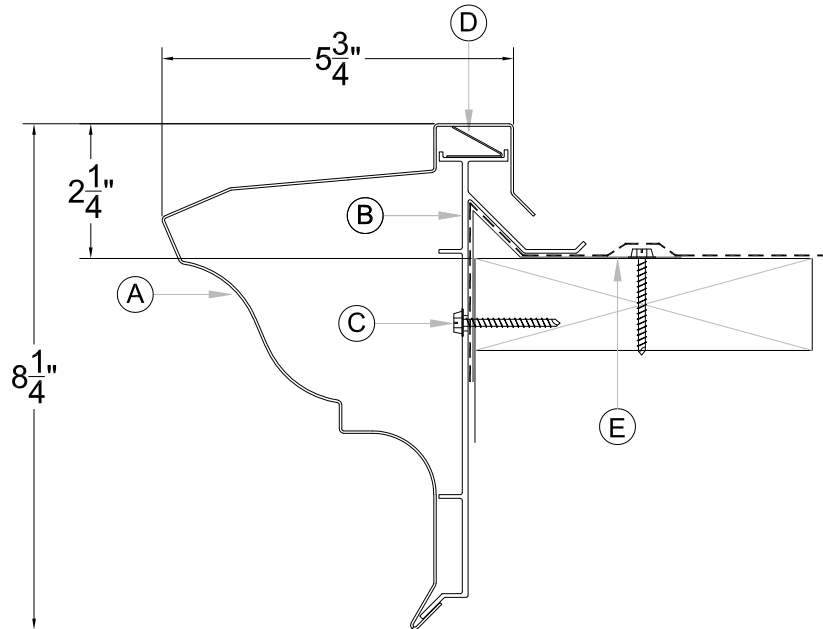

Legend:

- A: Snap-on Decorative Fascia, 10' lengths. Joint treatment consists of a $\frac{3}{8}$ " expansion reveal and 4" wide concealed splice plate.
B: Extruded Aluminum Secure Bar, 10' Length
C: #12 x 1.5" S.S. Wood Screws @ 12" centers
D: Stainless Steel Tension Clips @ 24" centers
E: Metal Edging by Installer

Material Options

Metal	Coping
Aluminum	
0.040	<input type="checkbox"/>
0.050	<input type="checkbox"/>
0.063	<input type="checkbox"/>
0.080	<input type="checkbox"/>
0.090	<input type="checkbox"/>
0.125	
0.1875	
0.250	
Copper	
16 oz	<input type="checkbox"/>
20 oz	<input type="checkbox"/>
32 oz	<input type="checkbox"/>

(Other Materials are Available upon Request)

Finish Options

Finish	Coping
EZ Mix Kynar	<input type="checkbox"/>
Custom Kynar	<input type="checkbox"/>
Anodized	<input type="checkbox"/>
Mill Finish	<input type="checkbox"/>

**Similar to the Standard Press-Loc Gravel Stop
Model PLGS-8.0 tested to meet
ANSI/SPRI/FM 4435/ES-1 and RE-2
Standard Requirements**

Designer Series Press-Loc Gravel Stop, Model PLGS.EC2-8: Press-Loc is designed to accommodate the rigid performance criteria of today's advanced roofing systems. It doesn't matter if your roof membrane is E.P.D.M., Thermoplastic, Modified Bitumen, or a Built-up Roof, Press-Loc fits them all. Press-Loc allows you to install your metal edging to be flashed in accordance with your membrane manufacturer's specifications. The Secure Bar profile fully encapsulates your membrane ensuring a watertight and leakproof edge. Press-Loc's unique and simple design make installation fast and economical, while giving you a leak-proof gravel stop edge that is extremely resistant to wind uplift.

(Default Selections are **BOLD**)

Customer:

Project:

Address:

Location:

Phone / Fax:

Architect:



SUBMITTAL / DATA SHEET

Designer Series Press-Loc Gravel Stop
Eclectic Collection

4 $\frac{1}{2}$ " Model PLGS.EC3-4

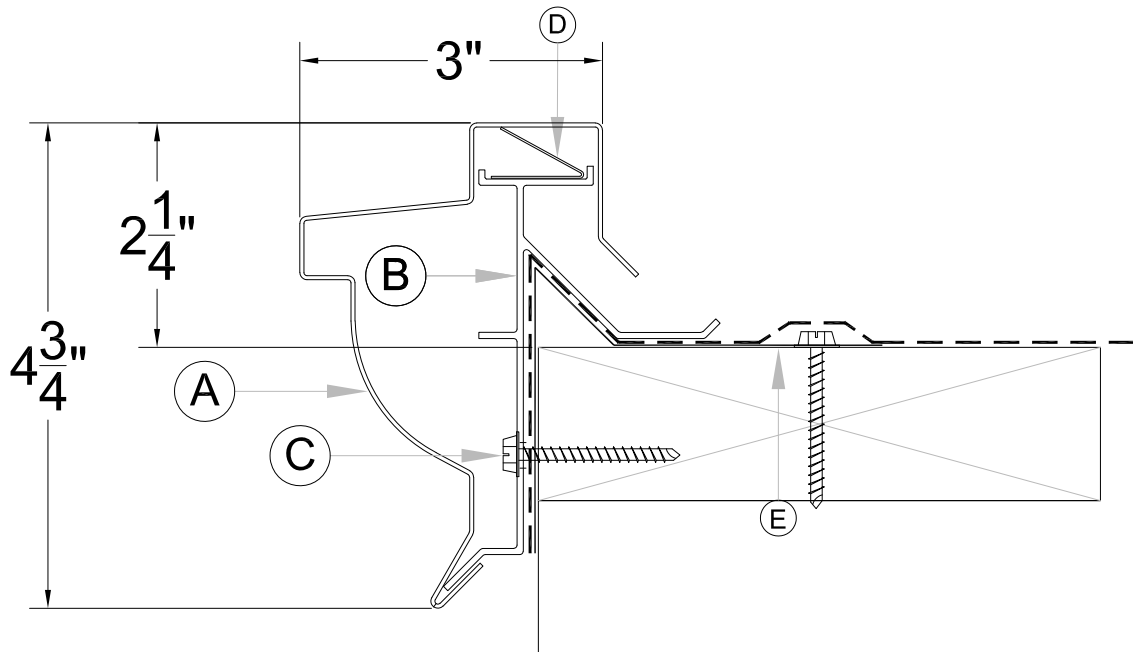

Legend:

- A: Snap-on Fascia, 10' lengths. Joint treatment consists of a $\frac{3}{8}$ " expansion reveal and 4" wide concealed splice plate.
B: Extruded Aluminum Secure Bar, 10' Length
C: #12 x 1.5" S.S. Wood Screws @ 12" centers
D: Stainless Steel Tension Clips @ 24" centers
E: Metal Edging by Installer

Material Options

Metal	Coping
Aluminum	
0.040	<input type="checkbox"/>
0.050	<input type="checkbox"/>
0.063	<input type="checkbox"/>
0.080	<input type="checkbox"/>
0.090	<input type="checkbox"/>
0.125	
0.1875	
0.250	
Copper	
16 oz	<input type="checkbox"/>
20 oz	<input type="checkbox"/>
32 oz	<input type="checkbox"/>

(Other Materials are Available upon Request)

Finish Options

Finish	Coping
EZ Mix Kynar	<input type="checkbox"/>
Custom Kynar	<input type="checkbox"/>
Anodized	<input type="checkbox"/>
Mill Finish	<input type="checkbox"/>

**Same tested design as PLGS-6.0 and PLGS-8.0
which meets ANSI/SPRI/FM 4435/ES-1 and RE-2
Standard Requirements . Testing not required**

Designer Series Press-Loc Gravel Stop, Model PLGS.EC3-4: Press-Loc is designed to accommodate the rigid performance criteria of today's advanced roofing systems. It doesn't matter if your roof membrane is E.P.D.M., Thermoplastic, Modified Bitumen, or a Built-up Roof, Press-Loc fits them all. Press-Loc allows you to install your metal edging to be flashed in accordance with your membrane manufacturer's specifications. The Secure Bar profile fully encapsulates your membrane ensuring a watertight and leakproof edge. Press-Loc's unique and simple design make installation fast and economical, while giving you a leak-proof gravel stop edge that is extremely resistant to wind uplift.

(Default Selections are **BOLD**)

Customer:

Project:

Address:

Location:

Phone / Fax:

Architect:



SUBMITTAL / DATA SHEET

Designer Series Press-Loc Gravel Stop
Eclectic Collection
6" Model PLGS.EC3-6

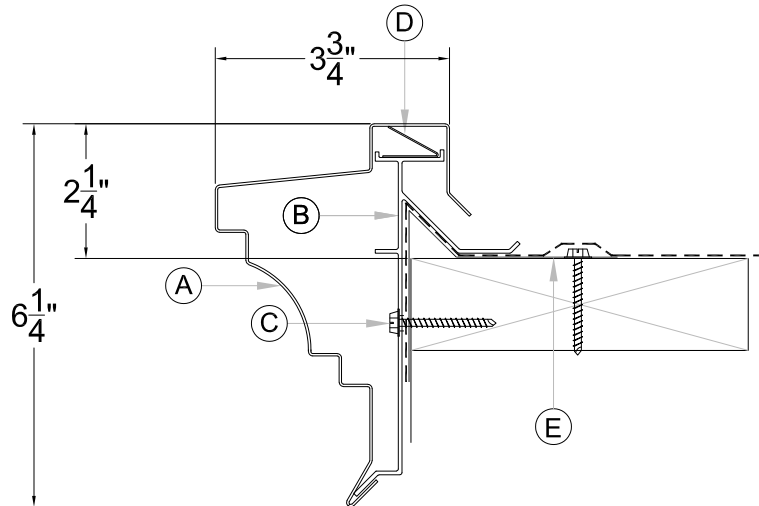

Legend:

- A: Snap-on Decorative Fascia, 10' lengths. Joint treatment consists of a $\frac{3}{8}$ " expansion reveal and 4" wide concealed splice plate.
B: Extruded Aluminum Secure Bar, 10' Length
C: #12 x 1.5" S.S. Wood Screws @ 12" centers
D: Stainless Steel Tension Clips @ 24" centers
E: Metal Edging by Installer

Material Options

Metal	Coping
Aluminum	
0.040	<input type="checkbox"/>
0.050	<input type="checkbox"/>
0.063	<input type="checkbox"/>
0.080	<input type="checkbox"/>
0.090	<input type="checkbox"/>
0.125	
0.1875	
0.250	
Copper	
16 oz	<input type="checkbox"/>
20 oz	<input type="checkbox"/>
32 oz	<input type="checkbox"/>

(Other Materials are Available upon Request)

Finish Options

Finish	Coping
EZ Mix Kynar	<input type="checkbox"/>
Custom Kynar	<input type="checkbox"/>
Anodized	<input type="checkbox"/>
Mill Finish	<input type="checkbox"/>

**Similar to the Standard Press-Loc Gravel Stop
Model PLGS-6.0 tested to meet
ANSI/SPRI/FM 4435/ES-1 and RE-2
Standard Requirements**

Designer Series Press-Loc Gravel Stop, Model PLGS.EC3-6: Press-Loc is designed to accommodate the rigid performance criteria of today's advanced roofing systems. It doesn't matter if your roof membrane is E.P.D.M., Thermoplastic, Modified Bitumen, or a Built-up Roof, Press-Loc fits them all. Press-Loc allows you to install your metal edging to be flashed in accordance with your membrane manufacturer's specifications. The Secure Bar profile fully encapsulates your membrane ensuring a watertight and leakproof edge. Press-Loc's unique and simple design make installation fast and economical, while giving you a leak-proof gravel stop edge that is extremely resistant to wind uplift.

(Default Selections are **BOLD**)

Customer:

Project:

Address:

Location:

Phone / Fax:

Architect:



SUBMITTAL / DATA SHEET

Designer Series Press-Loc Gravel Stop
Eclectic Collection
8" Model PLGS.EC3-8

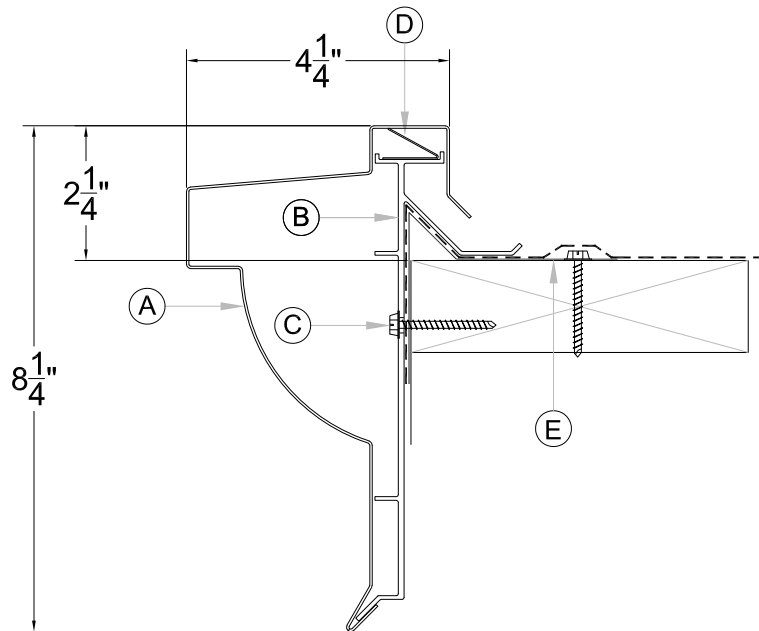

Legend:

- A: Snap-on Decorative Fascia, 10' lengths. Joint treatment consists of a $\frac{3}{8}$ " expansion reveal and 4" wide concealed splice plate.
B: Extruded Aluminum Secure Bar, 10' Length
C: #12 x 1.5" S.S. Wood Screws @ 12" centers
D: Stainless Steel Tension Clips @ 24" centers
E: Metal Edging by Installer

Material Options

Metal	Coping
Aluminum	
0.040	<input type="checkbox"/>
0.050	<input type="checkbox"/>
0.063	<input type="checkbox"/>
0.080	<input type="checkbox"/>
0.090	<input type="checkbox"/>
0.125	
0.1875	
0.250	
Copper	
16 oz	<input type="checkbox"/>
20 oz	<input type="checkbox"/>
32 oz	<input type="checkbox"/>

(Other Materials are Available upon Request)

Finish Options

Finish	Coping
EZ Mix Kynar	<input type="checkbox"/>
Custom Kynar	<input type="checkbox"/>
Anodized	<input type="checkbox"/>
Mill Finish	<input type="checkbox"/>

**Similar to the Standard Press-Loc Gravel Stop
Model PLGS-8.0 tested to meet
ANSI/SPRI/FM 4435/ES-1 and RE-2
Standard Requirements**

Designer Series Press-Loc Gravel Stop, Model PLGS.EC3-8: Press-Loc is designed to accommodate the rigid performance criteria of today's advanced roofing systems. It doesn't matter if your roof membrane is E.P.D.M., Thermoplastic, Modified Bitumen, or a Built-up Roof, Press-Loc fits them all. Press-Loc allows you to install your metal edging to be flashed in accordance with your membrane manufacturer's specifications. The Secure Bar profile fully encapsulates your membrane ensuring a watertight and leakproof edge. Press-Loc's unique and simple design make installation fast and economical, while giving you a leak-proof gravel stop edge that is extremely resistant to wind uplift.

(Default Selections are **BOLD**)

Customer:

Project:

Address:

Location:

Phone / Fax:

Architect:



SUBMITTAL / DATA SHEET

Designer Series Press-Loc Gravel Stop
Eclectic Collection

4 $\frac{1}{2}$ " Model PLGS.EC4-4

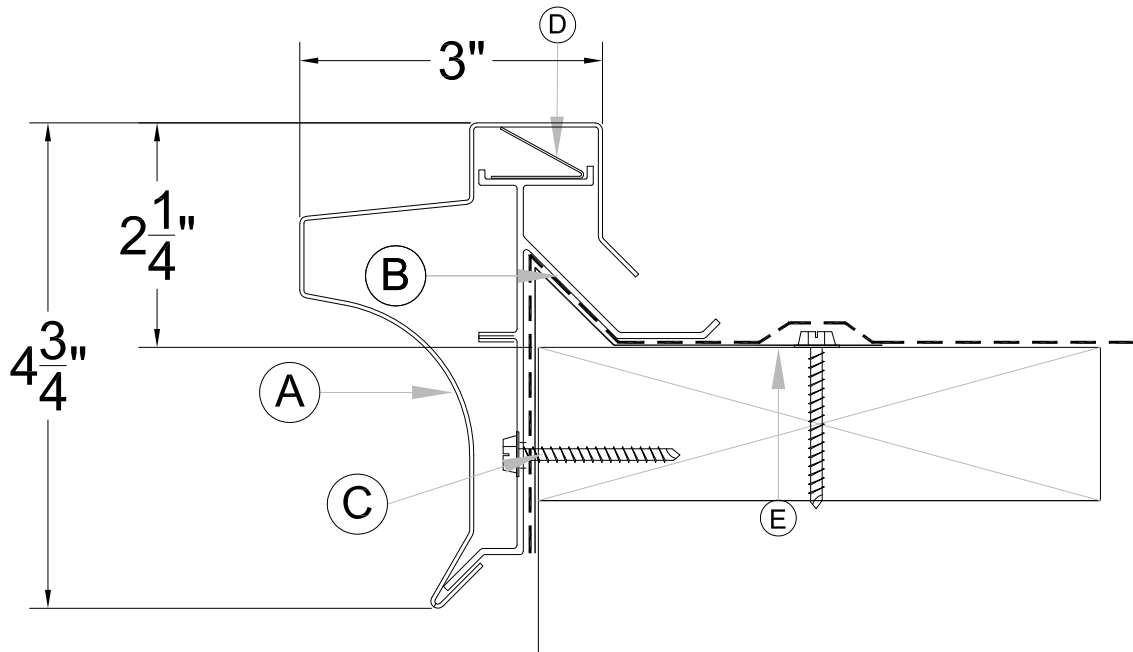

Legend:

- A: Snap-on Fascia, 10' lengths. Joint treatment consists of a $\frac{3}{8}$ " expansion reveal and 4" wide concealed splice plate.
B: Extruded Aluminum Secure Bar, 10' Length
C: #12 x 1.5" S.S. Wood Screws @ 12" centers
D: Stainless Steel Tension Clips @ 24" centers
E: Metal Edging by Installer

Material Options

Metal	Coping
Aluminum	
0.040	<input type="checkbox"/>
0.050	<input type="checkbox"/>
0.063	<input type="checkbox"/>
0.080	<input type="checkbox"/>
0.090	<input type="checkbox"/>
0.125	
0.1875	
0.250	
Copper	
16 oz	<input type="checkbox"/>
20 oz	<input type="checkbox"/>
32 oz	<input type="checkbox"/>

Finish Options

Finish	Coping
EZ Mix Kynar	<input type="checkbox"/>
Custom Kynar	<input type="checkbox"/>
Anodized	<input type="checkbox"/>
Mill Finish	<input type="checkbox"/>

Same tested design as PLGS-6.0 and PLGS-8.0 which meets ANSI/SPRI/FM 4435/ES-1 and RE-2 Standard Requirements . Testing not required

Designer Series Press-Loc Gravel Stop, Model PLGS.EC4-4: Press-Loc is designed to accommodate the rigid performance criteria of today's advanced roofing systems. It doesn't matter if your roof membrane is E.P.D.M., Thermoplastic, Modified Bitumen, or a Built-up Roof, Press-Loc fits them all. Press-Loc allows you to install your metal edging to be flashed in accordance with your membrane manufacturer's specifications. The Secure Bar profile fully encapsulates your membrane ensuring a watertight and leakproof edge. Press-Loc's unique and simple design make installation fast and economical, while giving you a leak-proof gravel stop edge that is extremely resistant to wind uplift.

(Other Materials are Available upon Request)

(Default Selections are **BOLD**)

Customer:

Project:

Address:

Location:

Phone / Fax:

Architect:



SUBMITTAL / DATA SHEET

Designer Series Press-Loc Gravel Stop
Eclectic Collection
6" Model PLGS.EC4-6

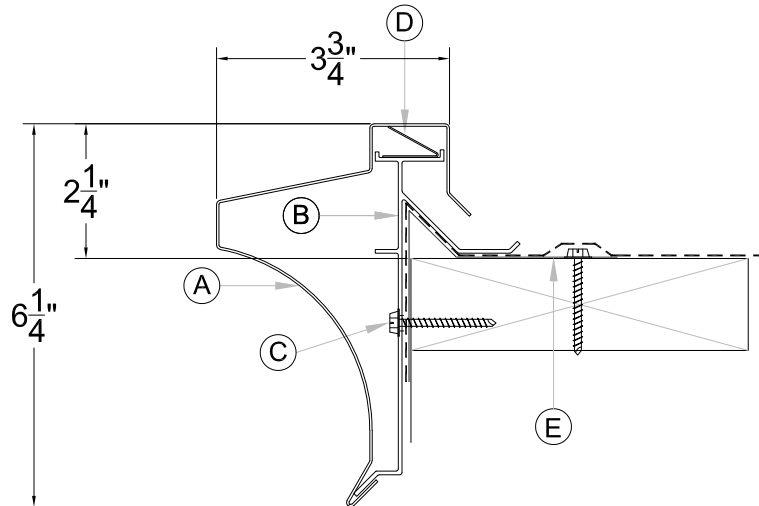

Legend:

- A: Snap-on Decorative Fascia, 10' lengths. Joint treatment consists of a $\frac{3}{8}$ " expansion reveal and 4" wide concealed splice plate.
B: Extruded Aluminum Secure Bar, 10' Length
C: #12 x 1.5" S.S. Wood Screws @ 12" centers
D: Stainless Steel Tension Clips @ 24" centers
E: Metal Edging by Installer

Material Options

Metal	Coping
Aluminum	
0.040	<input type="checkbox"/>
0.050	<input type="checkbox"/>
0.063	<input type="checkbox"/>
0.080	<input type="checkbox"/>
0.090	<input type="checkbox"/>
0.125	
0.1875	
0.250	
Copper	
16 oz	<input type="checkbox"/>
20 oz	<input type="checkbox"/>
32 oz	<input type="checkbox"/>

(Other Materials are Available upon Request)

Finish Options

Finish	Coping
EZ Mix Kynar	<input type="checkbox"/>
Custom Kynar	<input type="checkbox"/>
Anodized	<input type="checkbox"/>
Mill Finish	<input type="checkbox"/>

**Similar to the Standard Press-Loc Gravel Stop
Model PLGS-6.0 tested to meet
ANSI/SPRI/FM 4435/ES-1 and RE-2
Standard Requirements**

Designer Series Press-Loc Gravel Stop, Model PLGS.EC4-6: Press-Loc is designed to accommodate the rigid performance criteria of today's advanced roofing systems. It doesn't matter if your roof membrane is E.P.D.M., Thermoplastic, Modified Bitumen, or a Built-up Roof, Press-Loc fits them all. Press-Loc allows you to install your metal edging to be flashed in accordance with your membrane manufacturer's specifications. The Secure Bar profile fully encapsulates your membrane ensuring a watertight and leakproof edge. Press-Loc's unique and simple design make installation fast and economical, while giving you a leak-proof gravel stop edge that is extremely resistant to wind uplift.

(Default Selections are **BOLD**)

Customer:

Project:

Address:

Location:

Phone / Fax:

Architect:



SUBMITTAL / DATA SHEET

Designer Series Press-Loc Gravel Stop
Eclectic Collection
8" Model PLGS.EC4-8

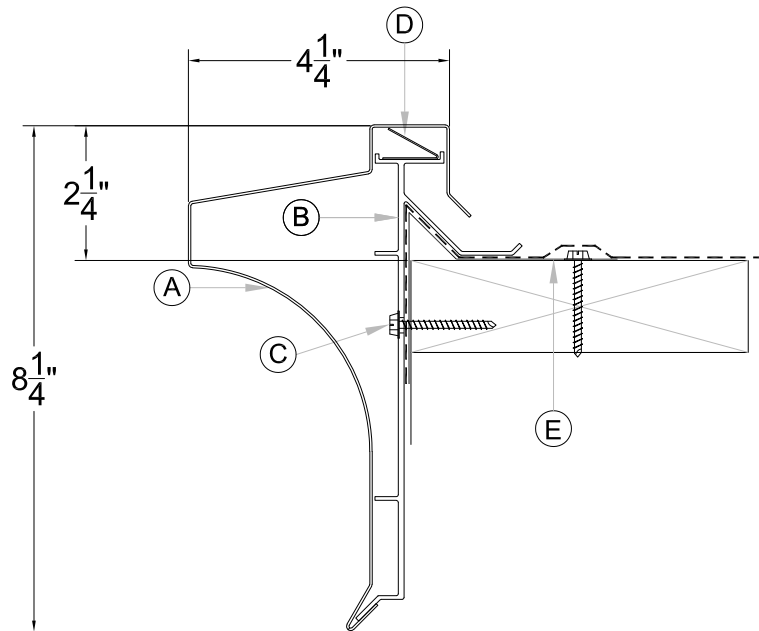

Legend:

- A: Snap-on Decorative Fascia, 10' lengths. Joint treatment consists of a $\frac{3}{8}$ " expansion reveal and 4" wide concealed splice plate.
B: Extruded Aluminum Secure Bar, 10' Length
C: #12 x 1.5" S.S. Wood Screws @ 12" centers
D: Stainless Steel Tension Clips @ 24" centers
E: Metal Edging by Installer

Material Options

Metal	Coping
Aluminum	
0.040	<input type="checkbox"/>
0.050	<input type="checkbox"/>
0.063	<input type="checkbox"/>
0.080	<input type="checkbox"/>
0.090	<input type="checkbox"/>
0.125	
0.1875	
0.250	
Copper	
16 oz	<input type="checkbox"/>
20 oz	<input type="checkbox"/>
32 oz	<input type="checkbox"/>

(Other Materials are Available upon Request)

Finish Options

Finish	Coping
EZ Mix Kynar	<input type="checkbox"/>
Custom Kynar	<input type="checkbox"/>
Anodized	<input type="checkbox"/>
Mill Finish	<input type="checkbox"/>

**Similar to the Standard Press-Loc Gravel Stop
Model PLGS-8.0 tested to meet
ANSI/SPRI/FM 4435/ES-1 and RE-2
Standard Requirements**

Designer Series Press-Loc Gravel Stop, Model PLGS.EC4-8: Press-Loc is designed to accommodate the rigid performance criteria of today's advanced roofing systems. It doesn't matter if your roof membrane is E.P.D.M., Thermoplastic, Modified Bitumen, or a Built-up Roof, Press-Loc fits them all. Press-Loc allows you to install your metal edging to be flashed in accordance with your membrane manufacturer's specifications. The Secure Bar profile fully encapsulates your membrane ensuring a watertight and leakproof edge. Press-Loc's unique and simple design make installation fast and economical, while giving you a leak-proof gravel stop edge that is extremely resistant to wind uplift.

(Default Selections are **BOLD**)

Customer:

Project:

Address:

Location:

Phone / Fax:

Architect: