

#### NOTES:

- A: DRYWALL OR PARGING (BY OTHERS) AS REQ'D.
- B: SEE DATASHEET OF THE INSTALLATION DRAWING FOR LANDING ENTRANCE SCHEDULE.
- C: ALL INFORMATION IS SUBJECT TO CHANGE.

#### GENERAL INFORMATIONS:

- EACH LANDING ENTRANCE SHALL BE SUPPLIED AS A FINISHED ASSEMBLY WITH GATE AND FRAME BLANKED, REINFORCED, DRILLED AND TAPPED FOR ALL COMPONENTS DETAILED, READY FOR INSTALLATION.
- DIFFERENT PANEL INSERT MATERIALS ARE OPTIONAL.
- DIFFERENT LOCKS SUCH AS GAL, OR WR500 ARE OPTIONAL.
- AUTO GATE: ANY OPERATOR IS PROVIDED.

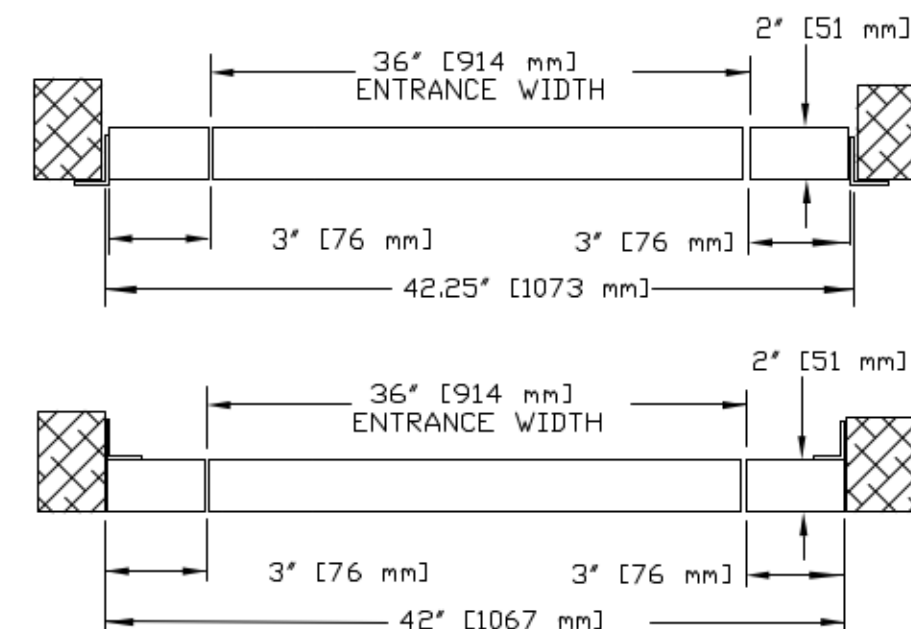

#### HORIZONTAL SECTION

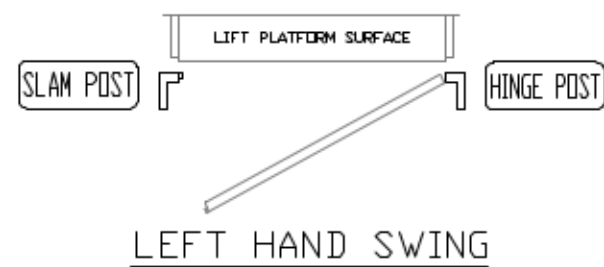
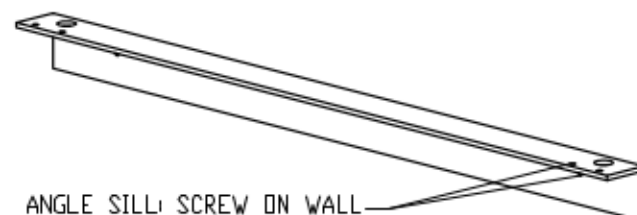
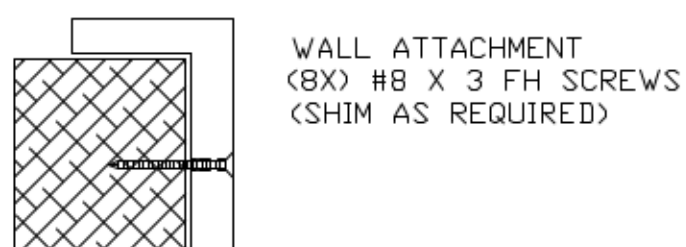

42 AUTO LH 36" HALF GATE

CUSTOMER:

PROJECT:

ADDRESS:

DATE:  
MM/DD/YY

REVISION DATE:  
MM/DD/YY

COMPLETED BY:  
A B



Part No.

Variant No.

**savaria**

JOB No.

JOB NUMBER

SHEET No.

1 OF 1