

SIDE VIEW

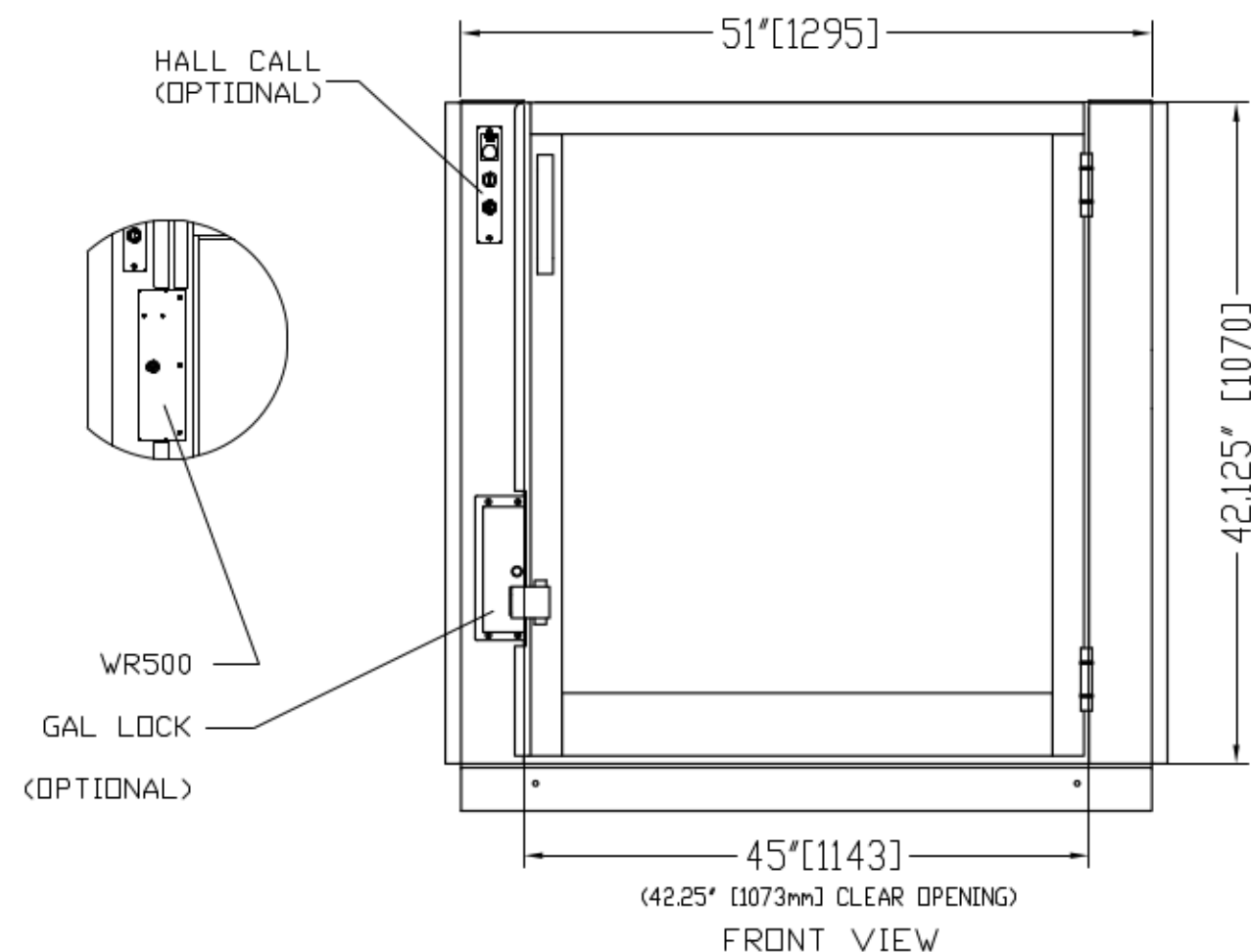

FRONT VIEW

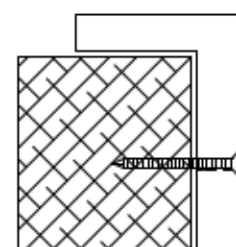

WALL ATTACHMENT
(8X) #8 X 3 FH SCREWS
(SHIM AS REQUIRED)

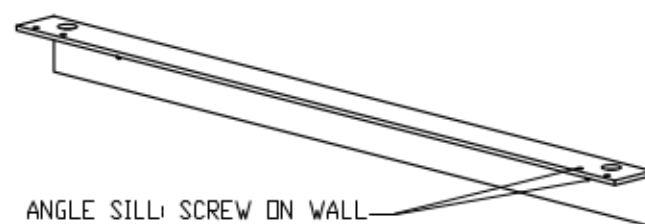

ANGLE SILL: SCREW ON WALL



LEFT HAND SWING

42 MANUAL LH HALF GATE
(42.25" [1073mm] CLEAR OPENING)

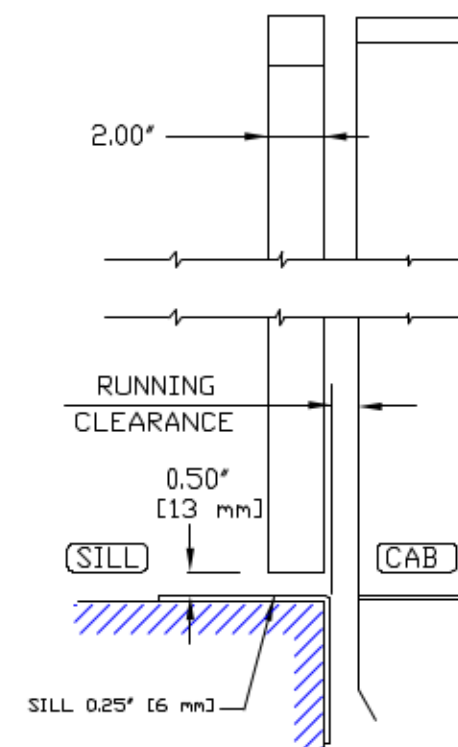

VERTICAL SECTION

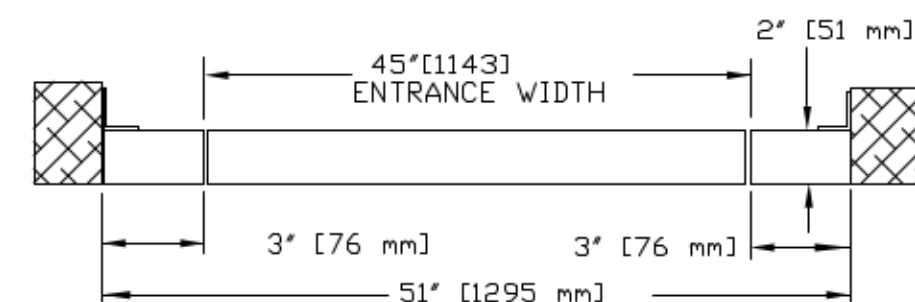
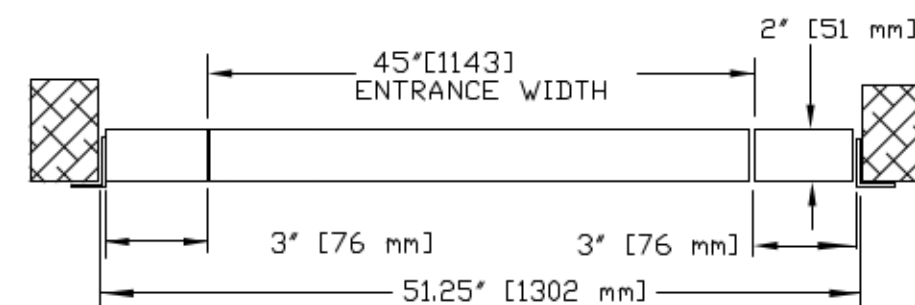

HORIZONTAL SECTION

NOTES:

- A: DRYWALL OR PARGING (BY OTHERS) AS REQ'D.
- B: SEE DATASHEET OF THE INSTALLATION DRAWING FOR LANDING ENTRANCE SCHEDULE.
- C: ALL INFORMATION IS SUBJECT TO CHANGE.

GENERAL INFORMATIONS:

- EACH LANDING ENTRANCE SHALL BE SUPPLIED AS A FINISHED ASSEMBLY WITH GATE AND FRAME BLANKED, REINFORCED, DRILLED AND TAPPED FOR ALL COMPONENTS DETAILED, READY FOR INSTALLATION.
- DIFFERENT PANEL INSERT MATERIALS ARE OPTIONAL.
- DIFFERENT LOCKS SUCH AS GAL, OR WR500 ARE OPTIONAL.
- MANUAL GATE: HYDRAULIC DOOR CLOSER IS PROVIDED.

CUSTOMER:

PROJECT:

ADDRESS:

DATE:

MM/DD/YY

REVISION DATE:

MM/DD/YY

COMPLETED BY:

A B

△

Part No.

Variant No.

savaria

JOB No.

JOB NUMBER

SHEET No.

1 OF 1