

SIDE VIEW

STAINLESS STEEL FINISH #4

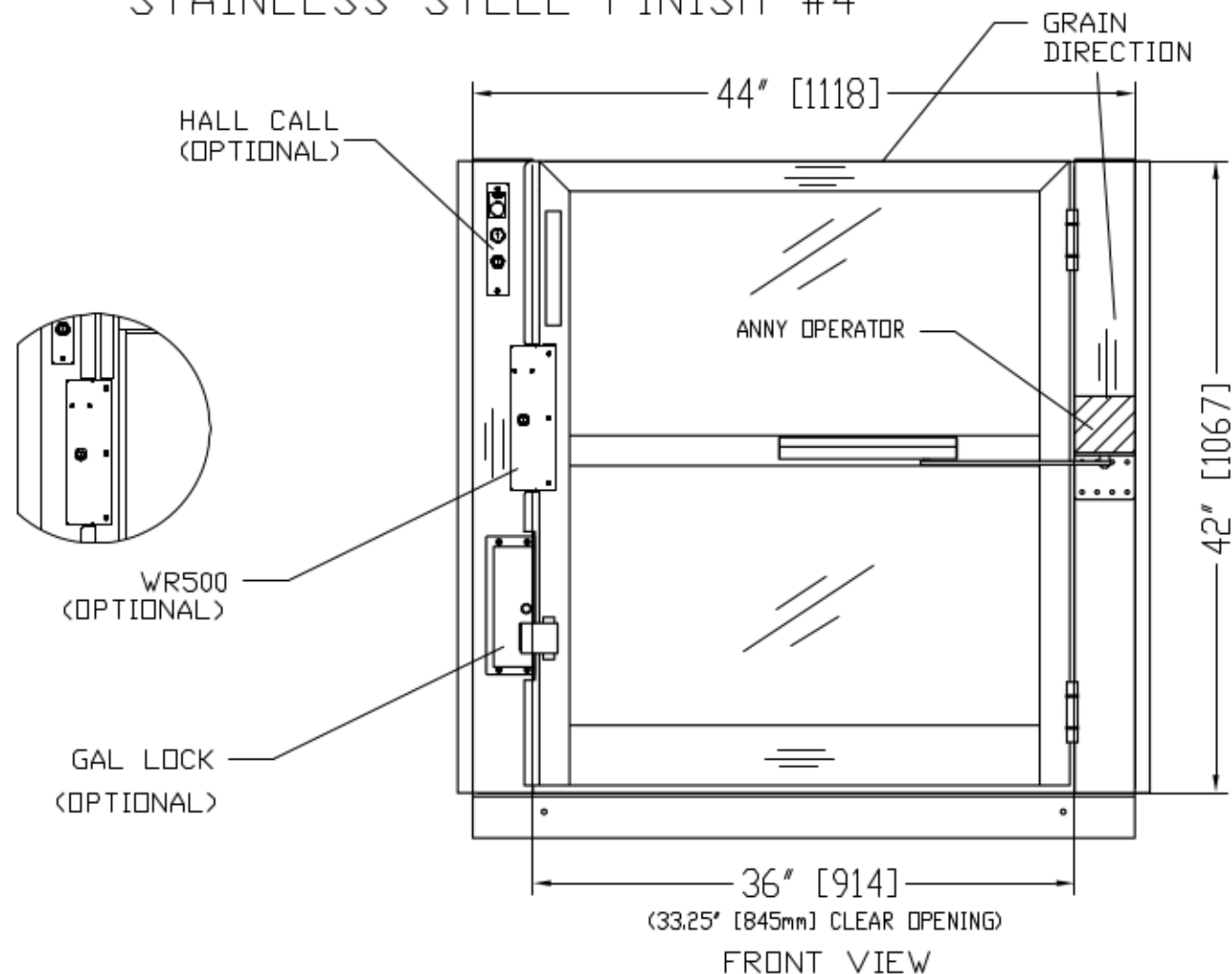

LEFT HAND SHOWN

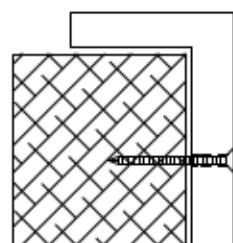

WALL ATTACHMENT
(8X) #8 X 3 FH SCREWS
(SHIM AS REQUIRED)

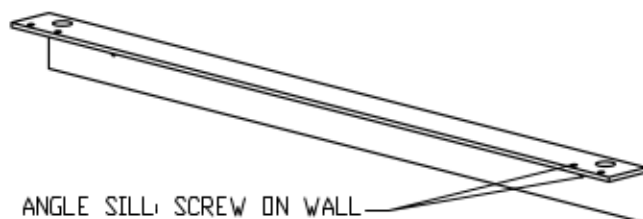

ANGLE SILL: SCREW ON WALL

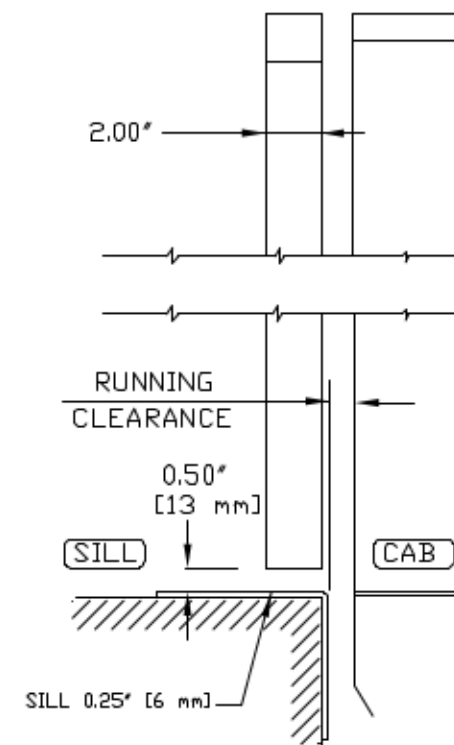

VERTICAL SECTION

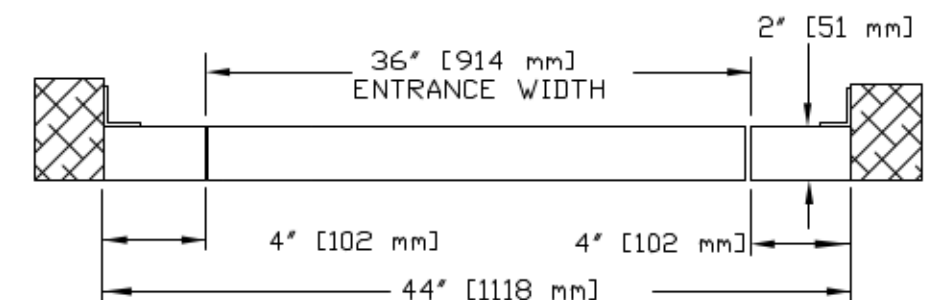
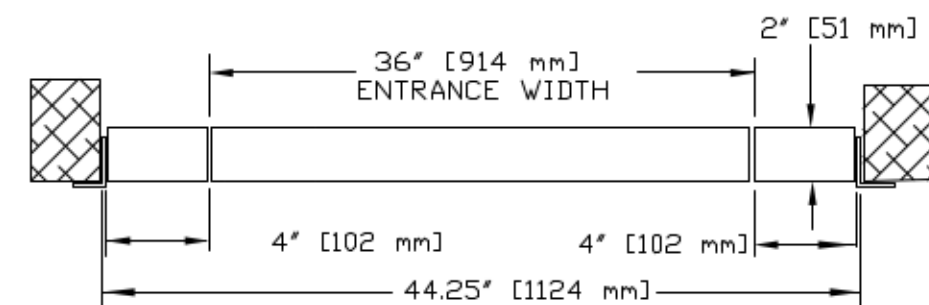

HORIZONTAL SECTION

NOTES:

- A: DRYWALL OR PARGING (BY OTHERS) AS REQ'D.
- B: SEE DATASHEET OF THE INSTALLATION DRAWING FOR LANDING ENTRANCE SCHEDULE.
- C: ALL INFORMATION IS SUBJECT TO CHANGE.

GENERAL INFORMATIONS:

- EACH LANDING ENTRANCE SHALL BE SUPPLIED AS A FINISHED ASSEMBLY WITH DOOR AND FRAME BLANKED, REINFORCED, DRILLED AND TAPPED FOR ALL COMPONENTS DETAILED, READY FOR INSTALLATION.
- DIFFERENT PANEL INSERT MATERIALS ARE OPTIONAL.
- DIFFERENT LOCKS SUCH AS GAL, ELECTRIC STRIKE, KWIK LOCK OR WR500 ARE OPTIONAL.
- AUTO GATE: ANNY OPERATOR IS PROVIDED.

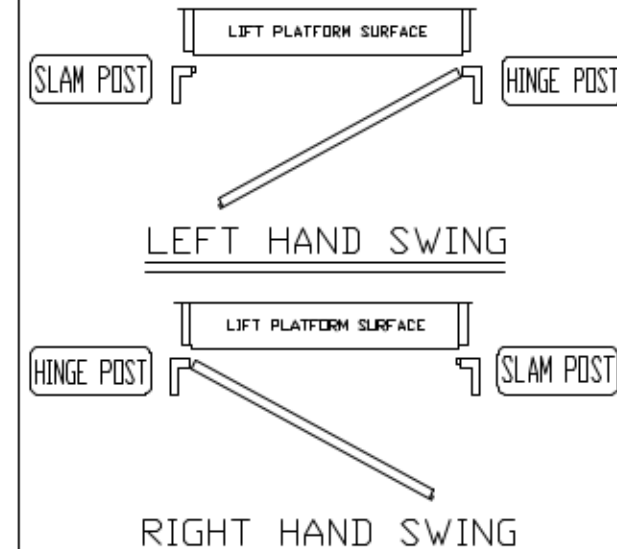

PANEL INSERT MATERIAL:

SUFFIX	DESCRIPTION
-C	CLEAR PLEXIGLASS
-B	BRONZE PLEXIGLASS
-TC	TEMPERED GLASS ETCHED FOR CANADA (ANSI Z97.1, 16 CFR, SECTIONS 120.1 AND 120.2, OR CAN/CGSB-12.1)
-TU	TEMPERED GLASS ETCHED FOR US (ANSI Z97.1, 16 CFR, SECTIONS 120.1 AND 120.2)
-LC	LAMINATED GLASS ETCHED FOR CANADA (ANSI Z97.1, 16 CFR, SECTION 120.4 OR CAN/CGSB-12.1)
-LU	LAMINATED GLASS ETCHED FOR CANADA (ANSI Z97.1, 16 CFR, SECTION 120.4)

42" AUTO 36" HALF GATE

CUSTOMER:

PROJECT:

ADDRESS:

DATE:

03/21/11

REVISION DATE:

MM/DD/YY

COMPLETED BY:

△ B

△

Part No.

Variant No.

savaria

JOB No.

SHEET No.

1 OF 1