

## SECTIONAL VIEW - ECLIPSE Model 36X54 TYPE 4

2 MOUNTING POSITIONS  
CENTER OR SIDE

**MOUNTING BRACKET**  
4 WALL ANCHOR POINTS MIN. PER BRACKET  
2 PER SIDE OF RAIL BRACKET CENTER LINE  
PULL OUT FORCE PER FASTENER 69 kg (152 LBS)

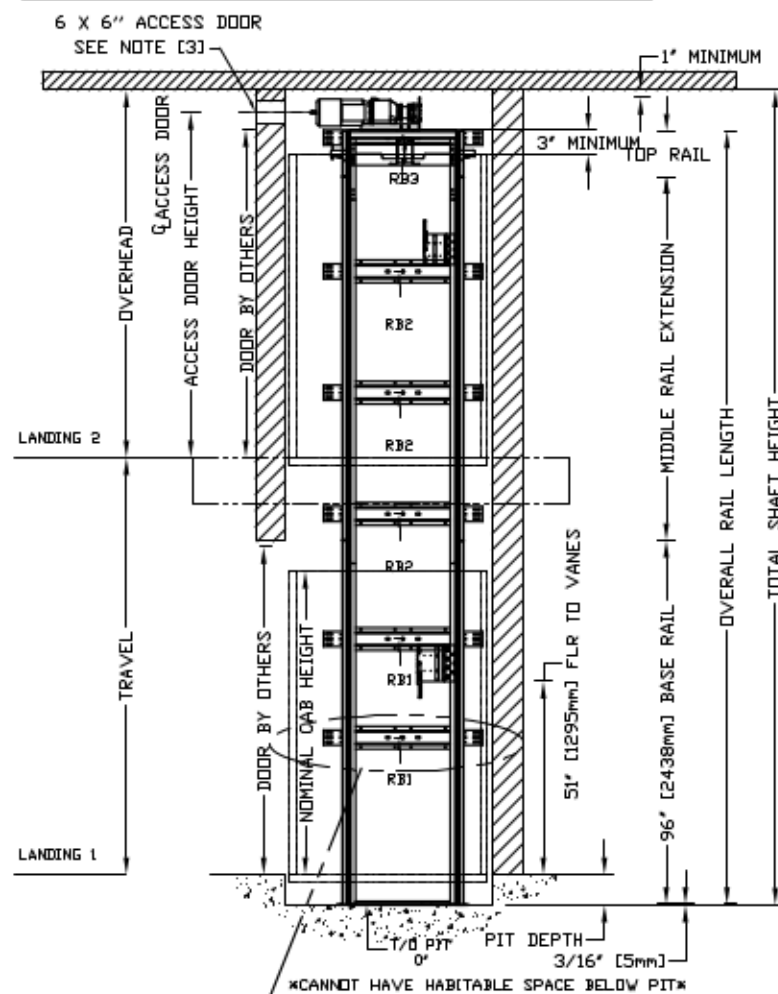
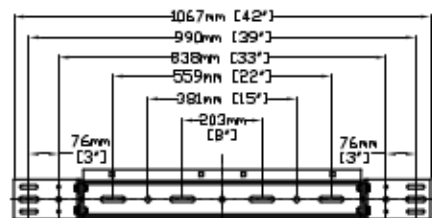
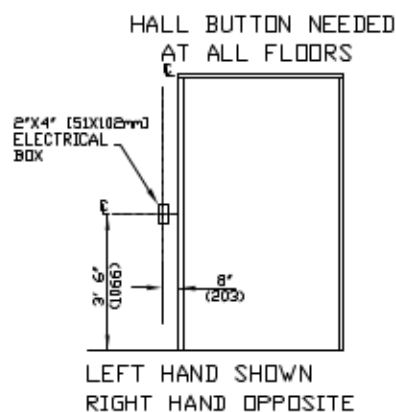

## DOOR SWING

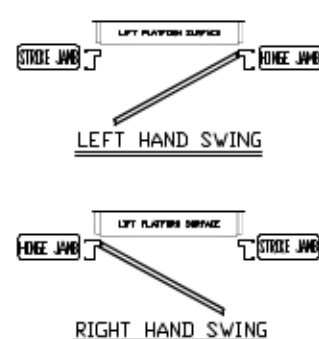

DOCUMENT REVISION 001, DATE: 10/09/08

## FORCES

RAIL FORCES	
*R1	*R2
138.2 kg (304 lbf)	88.2 kg (194 lbf)
RAIL ASSEMBLY WEIGHT: 0.80 lbf / ft	
PIT FORCE: R3	
PIT FLOOR TO SUPPORT LOAD (INCLUDES IMPACT)	
2909 kg (6400 lbf)	

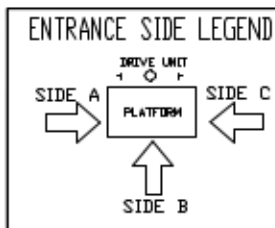

## CHARACTERISTICS

## GENERAL

APPLIED CODE: \_\_\_\_\_  
CAPACITY: \_\_\_\_\_ (750, 1000 LBS)  
NOMINAL SPEED: \_\_\_\_\_ 40 FPM  
TRAVEL: \_\_\_\_\_  
PIT DEPTH: \_\_\_\_\_ (MIN. 6")

## CAR DETAILS

CAB PANEL SELECTION: \_\_\_\_\_ (SEE CHART)  
CEILING SELECTION: \_\_\_\_\_ (WTH, MATCH)  
CAB FLOORING: \_\_\_\_\_ (PLYW, FINISH)  
FINISHED FLOOR THICKNESS: \_\_\_\_\_ (1/8 to 3/4")  
CAB HEIGHT: \_\_\_\_\_ (80, 96")  
CAB OPERATION: \_\_\_\_\_ (AUTO)  
GATE TYPE: \_\_\_\_\_ (VFOLD, CFOLD, CAB SILL: \_\_\_\_\_ SS)  
PFOLD CLR, PFOLD BRZ, BLK SCZR

## LOCKS/CALL STATIONS/TRAVEL/DOORS (BY OTHERS)

	LANDING 1	LANDING 2	LANDING 3	LANDING 4	MIN OVERHEAD=96/114"
TRAVEL	PIT:				OH:
ENTRANCE SIDE	SIDE	SIDE			HATCH: SIDE
DOOR SWING					
LOCK TYPE					SMARTLOCK (BY OTHERS) EMI, PORTA
AUTO DOOR OP.					

## STANDARD OPTIONS PROVIDED

BUTTON MARKING: NUMERIC (1 to 4)  
HALL CALL KEYED: NO  
HALL CALL FINISH: MATCH CAR STATION  
HALL CALL SHAPE: RECTANGULAR  
PREWIRE PACKAGE: NO  
CONTROLLER LOCATION: EXTERNAL

## DRIVE UNIT

DRIVE ASSEMBLY MFR. \_\_\_\_\_ CONCORD  
MOTOR \_\_\_\_\_ 2.0 HP/1660 RPM W/BRAKE  
GEAR MODEL \_\_\_\_\_ 42:17:1 Ratio Gear Box  
MOTOR CONTROLLER \_\_\_\_\_ Preprogrammed VF Drive.

## SUSPENSION

TYPE: \_\_\_\_\_ DUAL #60 ROLLER CHAIN  
CONSTRUCTION: \_\_\_\_\_ ANSI B29.1  
NOMINAL STRENGTH: \_\_\_\_\_ 9020 LBS PER CHAIN

## ELECTRICAL

POWER SUPPLY: \_\_\_\_\_ 60 Hz/1 Phase/230 volt

POT LIGHT FINISH (4): \_\_\_\_\_ (SS, BRZ, BRS)

TRIM COLOUR: \_\_\_\_\_ (CLR, BRZ)

CAR STATION PLATE (W/PD): \_\_\_\_\_ (CLR, BRZ, BRS, SS)

HAND RAIL TYPE: \_\_\_\_\_ (CLR, BRZ, BRS, SS)

TELEPHONE BOX: \_\_\_\_\_ (CLR, BRZ, BRS, SS)

GATES REQUIRED: \_\_\_\_\_ (AUTO, MAN)

## PLAN VIEW - ECLIPSE Model 36X54 TYPE 4

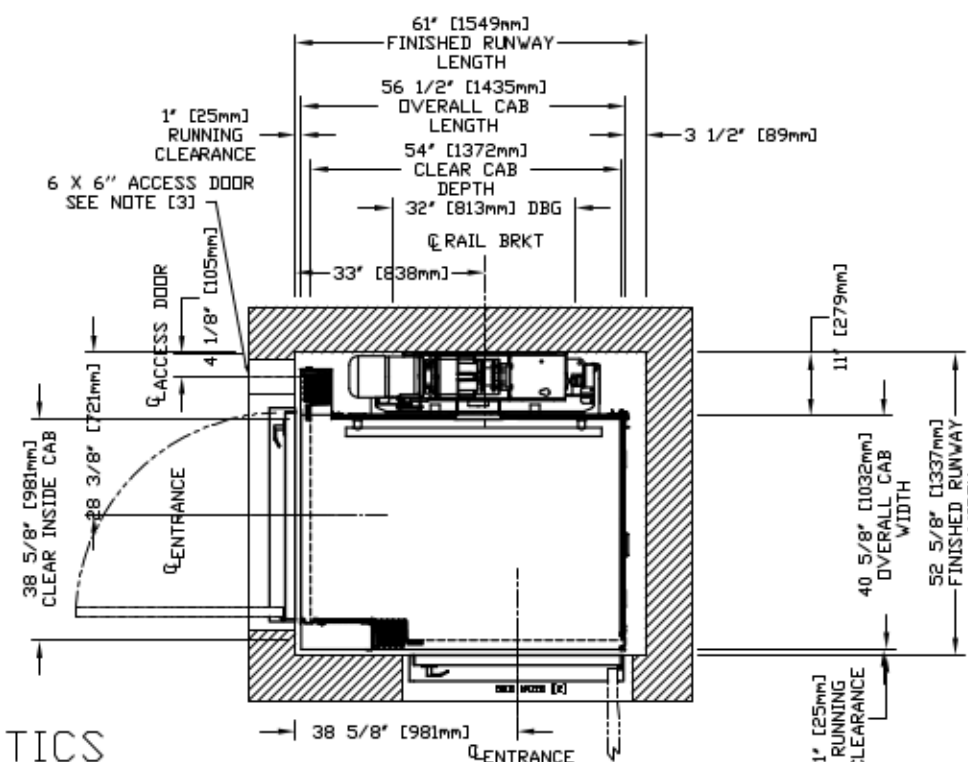

## PROVISIONS BY OTHERS

## \*HOISTWAY, CONSTRUCTION SITE, CLEARANCE

- 1- HOISTWAY CONSTRUCTION AND PIT BY OTHERS. DUE TO LIMITED SPACE WITHIN THE HOISTWAY IT IS ESSENTIAL THAT THE PIT IS LEVEL AND WALLS ARE SQUARE AND PLUMB THROUGHOUT THE HOISTWAY. THE HOISTWAY FRAMING MUST BE WITHIN 13 mm (1/2") OF PLUMB AND SQUARE FROM TOP TO BOTTOM FOR PROPER OPERATION OF THE ELEVATOR THROUGHOUT THE HOISTWAY.
- 2- DISTANCE BETWEEN THE HOISTWAY SIDE OF THE LANDING DOOR AND THE CAR DOOR OR GATE SHALL NOT EXCEED 4" (102 mm) USING THE CODE MEASURING TOOL. FOR ACCORDION (PANEL FOLD) GATES, YOU MUST HAVE FLUSH DOORS (NOT THE 3/4" SETBACK). 3/4" SETBACK IS POSSIBLE ONLY WHEN THE CAR DOORS ARE BIFOLD OR SLIDING DOORS. RECOMMEND SOLID CORE DOOR SLAB
- 3- HOISTWAY MUST HAVE A MINIMUM 152 mm x 152 mm (6" x 6") LOCKABLE ACCESS HATCH (PROVIDED BY SAVARIA CONCORD) LOCATED AT THE TOP OF THE HOISTWAY. LOCATION MUST BE IN AN AREA WHICH WILL PROVIDE ACCESS TO THE ELEVATOR DRIVE ASSEMBLY BY THE MANUAL LOWERING HANDLE. MANUAL LOWERING HANDLE WILL ENABLE USER TO OVERPOWER BRAKE AND LOWER CAR WITHOUT BODILY ENTRY TO THE SHAFTWAY.
- 4- THE PIT FLOOR SHALL BE CONSTRUCTED TO WITHSTAND AN IMPACT LOAD OF 2903 KG (6400 LBS). REF. CSA B44 SECTION 2.11 (ASME/ANSI A17.1 SECTION 10.6)
- 5- HOISTWAY TO BE FREE OF ALL PIPES, WIRING AND OBSTRUCTIONS NOT RELATED TO THE OPERATION OF THE ELEVATOR.
- 6- HOISTWAY CONSTRUCTION REQUIREMENTS MAY VARY FROM REGION TO REGION. DIMENSIONS GIVEN ARE MANUFACTURER'S RECOMMENDED CLEARANCES. THEY REFLECT THE RUNNING AND ACCESS CLEARANCES. CONSULT YOUR LOCAL AUTHORITY TO ASSURE COMPLIANCE WITH PROVINCE AND LOCAL CODES.

## DIMENSIONS WARNING

CONTRACTOR/CUSTOMER TO VERIFY ALL DIMENSIONS AND REPORT ANY DISCREPANCIES TO OUR OFFICE IMMEDIATELY.

## \*STRUCTURAL

- 7- A LOAD BEARING WALL IS REQUIRED TO SUSTAIN RAIL REACTIONS AS SPECIFIED IN KEY TO RAIL REACTIONS ON DRAWING BUILDING CONTRACTOR TO CONTACT STRUCTURAL ENGINEER TO DETERMINE IF SUPPORTING WALL WILL SUSTAIN RAIL REACTIONS. FOR COMPLYING WITH LOCAL CODES.
- 8- SUITABLE LINTELS MUST BE PROVIDED BY OWNER/AGENT. DOOR FRAMES ARE NOT DESIGNED TO SUPPORT OVERHEAD WALL LOADS.
- 9- ALL FULL HEIGHT DOORS MUST BE ALIGNED WITH THE DOOR CENTERLINE SHOWN ON PLAN DETAIL. RECOMMEND INSTALLING A SOLID CORE 2032 mm (6'-8") HIGH DOOR WITH A MINIMUM CLEAR OPENING OF 813 mm (2'-8") WIDE.
- 10- DOOR HANDLE AND LATCH SET LATCH SET REQUIRED FOR ALL FULL SIZE DOORS.
- 11- SEE INSTALLATION MANUAL FOR DETAILS ON THE INTERLOCKS. INTERLOCKS ARE REQUIRED FOR ALL FULL SIZE DOORS.

## \*ELECTRICAL

- 12- THE ELEVATOR CONTROLLER IS 620 mm (24.4") WIDE X 584 mm (23") HIGH X 170 mm (6.7") DEEP. THE CONTROLLER IS PROVIDED BY SAVARIA CONCORD AND IS EITHER:  
A: ATTACHED TO THE RAIL WALL INSIDE THE HOISTWAY BETWEEN THE 4" RAILS WITH ACCESS EITHER UNDER THE CAB OR THROUGH THE CAB OF THE ELEVATOR; OR  
B: IN A REMOTE LOCATION EXTERNAL TO HOISTWAY, THAT NEEDS PROPER STRUCTURAL WALL TO SUPPORT THE CONTROLLER ON ALL 4 CORNERS HOLES POSITION ARE 597 mm (23.5") WIDE BY 546 mm (21.5") HIGH
- 13- ARRANGE FOR A POWER SUPPLY WITHIN SIGHT OR NEXT TO THE ELEVATOR CONTROLLER PRIOR TO DELIVERY OF THE UNIT (BOTH 115 VOLT AND 208/240 VOLT). THE 208/240 VOLT CIRCUIT SHALL ORIGINATE FROM A LOCKABLE 2 POLE FUSED DISCONNECT (20 AMP RK 5 RATED FUSE) LOCATED NEAR THE RESIDENCES INCOMING ELECTRICAL PANEL. THE ELECTRICAL CIRCUIT PROVIDED FOR THE CONTROLLER SHALL BE, 208/240 VOLT, SINGLE PHASE, DEDICATED CIRCUIT WITH NEUTRAL AND GROUND. FUSING MUST BE SELECTIVELY COORDINATED. FUSE 208/240 VOLT FOR 20 AMP SERVICE. FUSE 115 VOLT FOR 15 AMP SERVICE FOR CAR LIGHT. A LOCKABLE AUXILIARY 240 VOLT AND 115 VOLT DISCONNECT IS REQUIRED INSIDE THE HOISTWAY OR IN SIGHT OF THE CONTROLLER. ALL ELECTRICAL TO DISCONNECTS SHALL BE PROVIDED AND INSTALLED BY OTHERS (MUST COMPLY WITH APPLICABLE CODES).
- 14- FIELD ELECTRICAL WIRING AND CONNECTIONS TO HALL-CALLS, PIT SWITCH AND INTERLOCKS ARE PROVIDED.
- 15- THE ILLUMINATION SHALL BE NOT LESS THAN 200 LX (19 FC) AT THE FLOOR LEVEL IN ALL MACHINE ROOMS AND MACHINERY SPACES. THE SWITCH FOR THE LIGHT MUST BE WITHIN 457 mm (18") OF THE HOISTWAY ACCESS. THE LIGHT MUST BE GUARDED TO PREVENT ACCIDENTAL BREAKAGE OR CONTACT WITH THE HOT BULB. THE SWITCH, LIGHT, AND GUARD ARE PROVIDED AND INSTALLED BY OTHERS. (MUST COMPLY WITH APPLICABLE CODES).
- 16- IF A TELEPHONE CIRCUIT IS REQUIRED (OPTION FOR ELEVATOR) JACK IS PROVIDED AND INSTALLED BY OTHERS. THIS CIRCUIT SHALL BE BROUGHT TO A LOCATION NEXT TO THE CONTROLLER AND BE AVAILABLE TO CONNECT AND TEST UPON ELEVATOR INSTALLATION
- 17- WHEN CONTROLLER EXTERNAL  
LOCATION / ACCESS- "CONTROLLER ROOM" LOCATED AT THE LOWEST LEVEL ADJACENT TO HOISTWAY, UNLESS SHOWN OTHERWISE ON THE LAYOUT DRAWINGS. FIELD ADJUSTMENT BY INSTALLER MAY BE NECESSARY TO MEET JOB SITE CONDITIONS OR REGULATIONS. ACCESS TO CONTROLLER ROOM TO BE THROUGH A SELF CLOSING LOCKABLE DOOR WHERE CODE CONSIDER IT AS A MACHINE ROOM

## \*WHEN APPLICABLE SLEEVES FOR ELECTRIC LINES-

- 18- FROM CONTROLLER ROOM TO RUNWAY AS REQUIRED.  
(POSITION PER INSTALLERS INSTRUCTIONS).

## \*CODE

19. ALTHOUGH THE ELEVATOR IS DESIGNED TO MEET CSA B44 (ANSI A17.1), LOCAL CODES MAY VARY. DEALER IS RESPONSIBLE FOR COMPLYING WITH LOCAL CODES.
- NOTE A:  
ALL COMPONENTS WEIGHTS CAN BE FOUND IN THE PLANNING GUIDE
- NOTE B:  
ALL INFORMATION IS SUBJECT TO CHANGE.  
PLEASE REFERENCE OUR ON-LINE DRAWINGS AT  
[www.savariaconcord.com](http://www.savariaconcord.com) FOR THE MOST RECENT UPDATES

RESIDENTIAL ELEVATOR  
ECLIPSE MODEL 36X54 TYPE 4

CUSTOMER:	DATE:	THE INFORMATION DISCLOSED HEREIN IS THE EXCLUSIVE PROPERTY OF
PROJECT:	REVISION DATE:	<b>savaria</b>
LOCATION:	COMPLETED BY:	SHEET 1/1