

8

7

6

5

4

3

2

1

COVER SELECTION				
SELECTION	PART NUMBER	HEIGHT (H)	FITS BOLLARD SIZE (I.D.)	MATERIAL
	BCL4F0836-6	36"	6"	304 SS
	BCL4F0842-6	42"		
	BCL4F0846-6	46"		
	BCL6F0836-6	36"		316L SS
	BCL6F0842-6	42"		
	BCL6F0846-6	46"		

NOTE: BOLLARD SHOULD BE 7" SHORTER THAN OVERALL LENGTH OF COVER

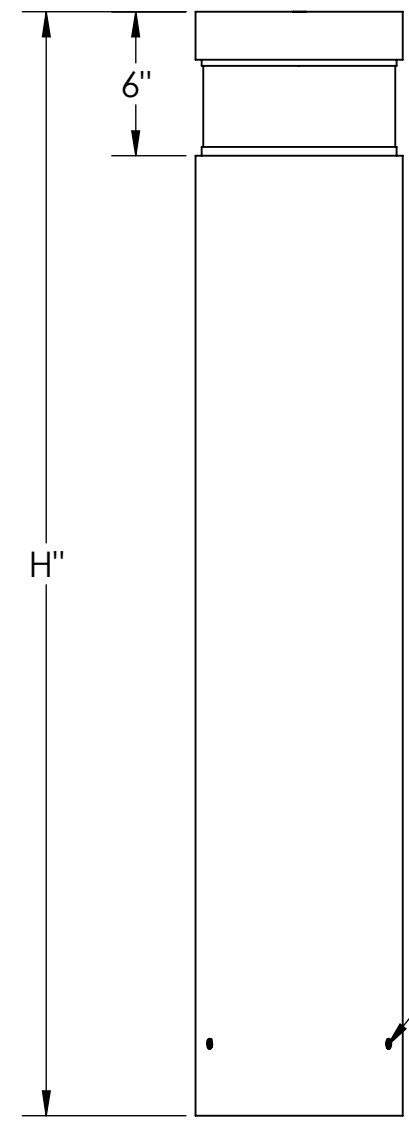
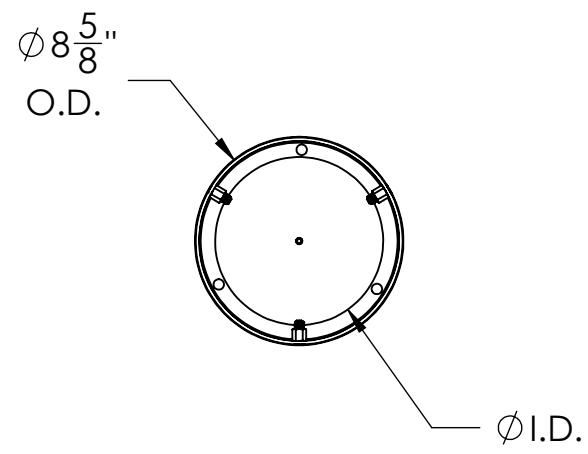

QTY 3 SET SCREWS FOR SECURING COVER TO BOLLARD

- LIGHTING INFORMATION:
1. COOL WHITE - 3W LED STANDARD
  2. OTHER COLORS AVAILABLE
  3. 456 LUMENS STANDARD (MORE AVAILABLE)
  4. 12V POWER REQUIRED
  5. TRANSFORMER PROVIDED BY OTHERS
  6. STANDARD CLEAR LENS, OPTIONAL FROSTED LENS AVAILABLE

#4 CIRCUMFERENTIAL BRUSHED FINISH



NOTE: OTHER MATERIALS/FINISHES AVAILABLE - CONTACT FOR MORE INFORMATION

NO MANUAL REVISIONS/CHANGES ALLOWED

	NAME	DATE
DRAWN BY	S.J.	1/30/2020
CHECKED BY	J.HU.	1/30/2020

**BARRIER DEFENSE SYSTEMS**  
A SHAW STAINLESS COMPANY

986 ROSEDALE DR.  
HIRAM, GA 30141  
(678) 915-2080

DESCRIPTION:  
8" LIGHTED BOLLARD COVER

REV. ITEM NO:  
SEE SELECTOR

PROPRIETARY AND CONFIDENTIAL  
THE INFORMATION CONTAINED IN THIS DRAWING IS THE SOLE PROPERTY OF SHAW STAINLESS LLC.  
ANY REPRODUCTION IN PART OR AS A WHOLE WITHOUT THE WRITTEN PERMISSION OF SHAW STAINLESS LLC IS PROHIBITED.

SHEET 1 OF 1

8

7

6

5

4

3

2

1