

Optional
Vent Slots

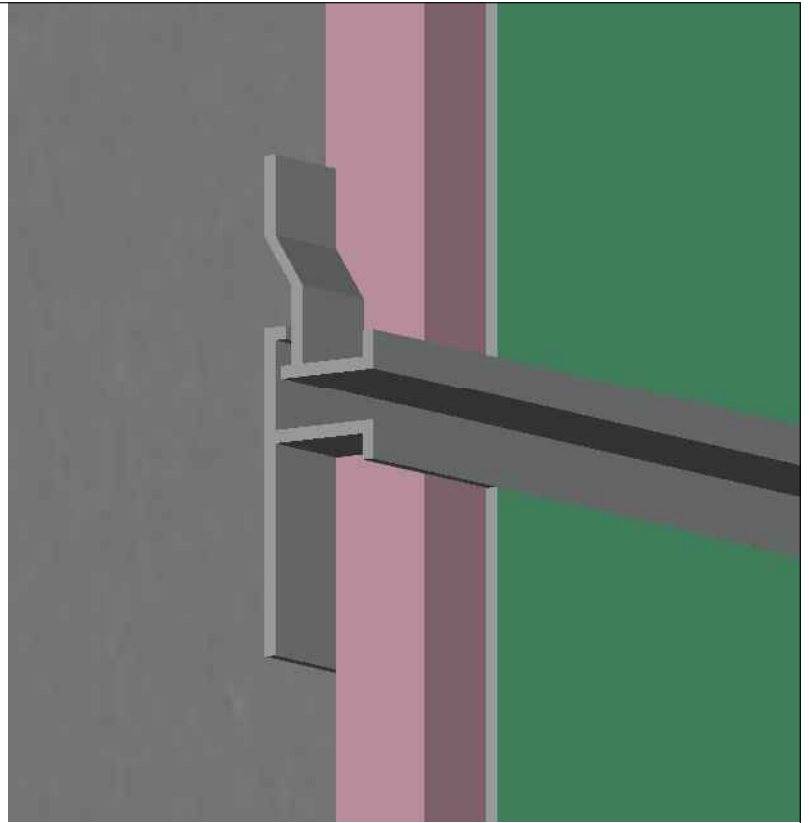

Specifications

Length	X Size	Y Size
10'	1/2"	1/4"
	3/4"	1/2"
		3/4"
		1"
		1 1/2"
		2"

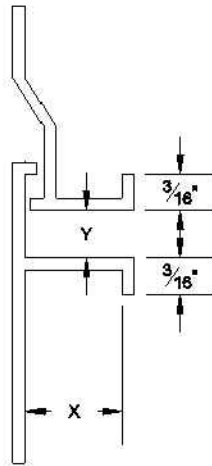
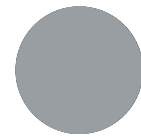

Aluminum Alloy
(6063 T-5)



**Drywall Channel
Screed 50 - 2 pc.**

Detail: DCS 50-2

Scale: 12" = 1'

Rev: R1 - 2017-04

Stockton Products - 4675 Vandenberg Drive - North Las Vegas, NV 89081 - Ph: 87-STOCKTON