

4

3

2

1

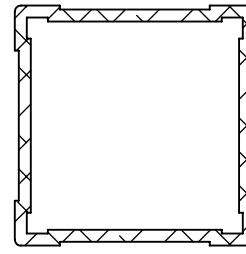

POST WITH PLATE SIZES:
 -2 1/2" SQUARE (LINE POST ONLY)
 -3 1/4" SQUARE (LINE, END POST or *PORCH POST)
 -4" (*PORCH POST ONLY)
 (2 1/2 & 3 1/4 AVAILABLE IN 38" or 44" height)
 *PORCH IS 108" IN HEIGHT

REVISIONS			
REV.	DESCRIPTION	DATE	BY
-	INITIAL RELEASE	7/29/2020	EH
01	REMOVED "STAIR" FROM DESCRIPTION. MADE STAIR OWN DRAWING	11/16/2020	EH
02	UPDATED DRAWINGS FOR CLARITY	11/11/2022	JC
03	ADJUSTED TO STANDARD	12/29/2022	JC

SNAP CAP TOP OPTIONS:
 - AMERICAN SERIES
 - CHESAPEAKE SERIES

1/8" STAINLESS STEEL CABLE (31" OR 37")

1/2" STAINLESS STEEL VERTICAL SUPPORT (31" OR 37")

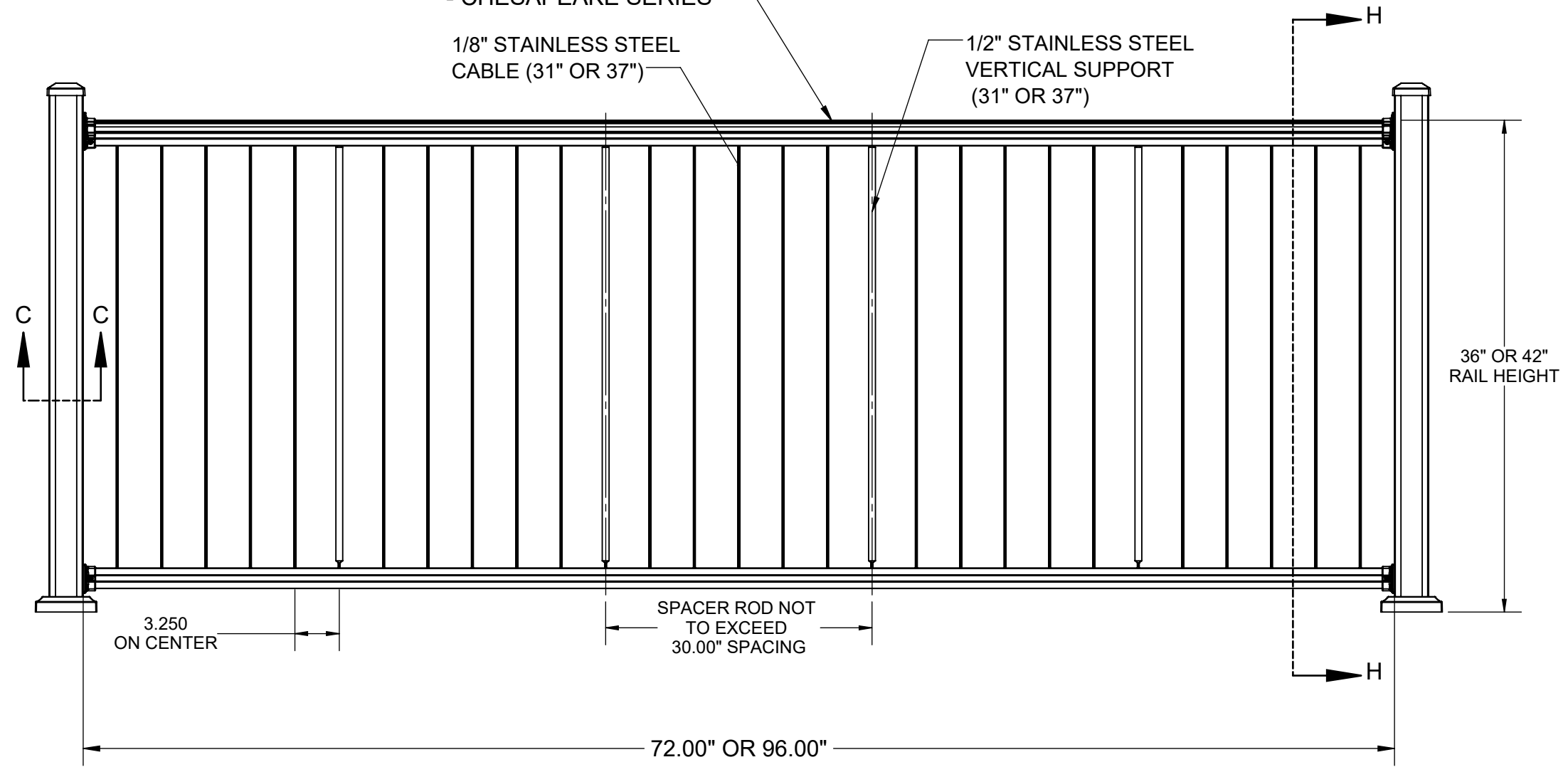

AMERICAN SERIES RAIL PROFILE

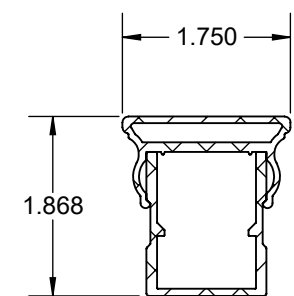

DETAIL J SCALE 1 : 2

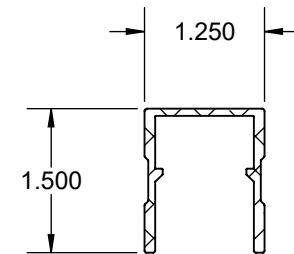

DETAIL K SCALE 1 : 2

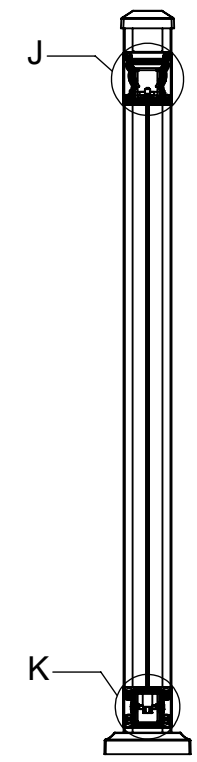

SECTION H-H

PROPRIETARY AND CONFIDENTIAL
 THE INFORMATION CONTAINED IN THIS DRAWING IS THE PROPERTY OF **KEY-LINK FENCING & RAILING**. ANY REPRODUCTION IN PART OR IN WHOLE WITHOUT THE WRITTEN PERMISSION OF **KEY-LINK FENCING & RAILING** IS PROHIBITED.

DRAWN BY	NAME	DATE
MODELED BY	D.Kinsey	7/7/2020
APPROVED BY	D.Kinsey	07/06/2020
	D.Kinsey	11/17/2020
PROJECTION	UNLESS OTHERWISE SPECIFIED: 1. DIMENSIONS ARE IN INCHES 2. BREAK ALL SHARP EDGES 3. TOLERANCES: FRACTIONAL ± 1/64" ANGULAR:MACH ±1.0° BEND ±1.0° TWO PLACE DECIMAL ±0.01" THREE PLACE DECIMAL ±0.005"	
DO NOT SCALE DRAWING		
FINISH	MATERIAL SEE BILL OF MATERIALS	
N/A		

Key-Link Fencing & Railing, Inc
 150 Orlan Road, New Holland, PA 17557

TITLE: **VERTICAL CABLE INFILL, 36"/42"HT. X 6'/8"W. LEVEL**

SIZE B	DWG. NO. 109493	REV 03
SCALE: 1:10	WEIGHT: 37.1193	SHEET 1 OF 1

4

3

2

1

B

B

A

A