

REVISIONS			
REV.	DESCRIPTION	DATE	BY
-	INITIAL RELEASE	12/9/2022	JC
01	ADJUSTED TO STANDARD	1/4/2023	JC

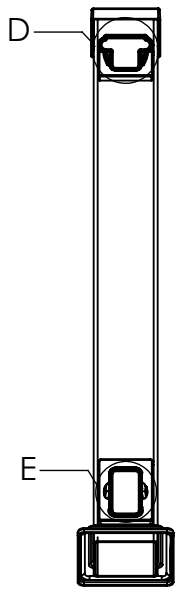

SECTION A-A

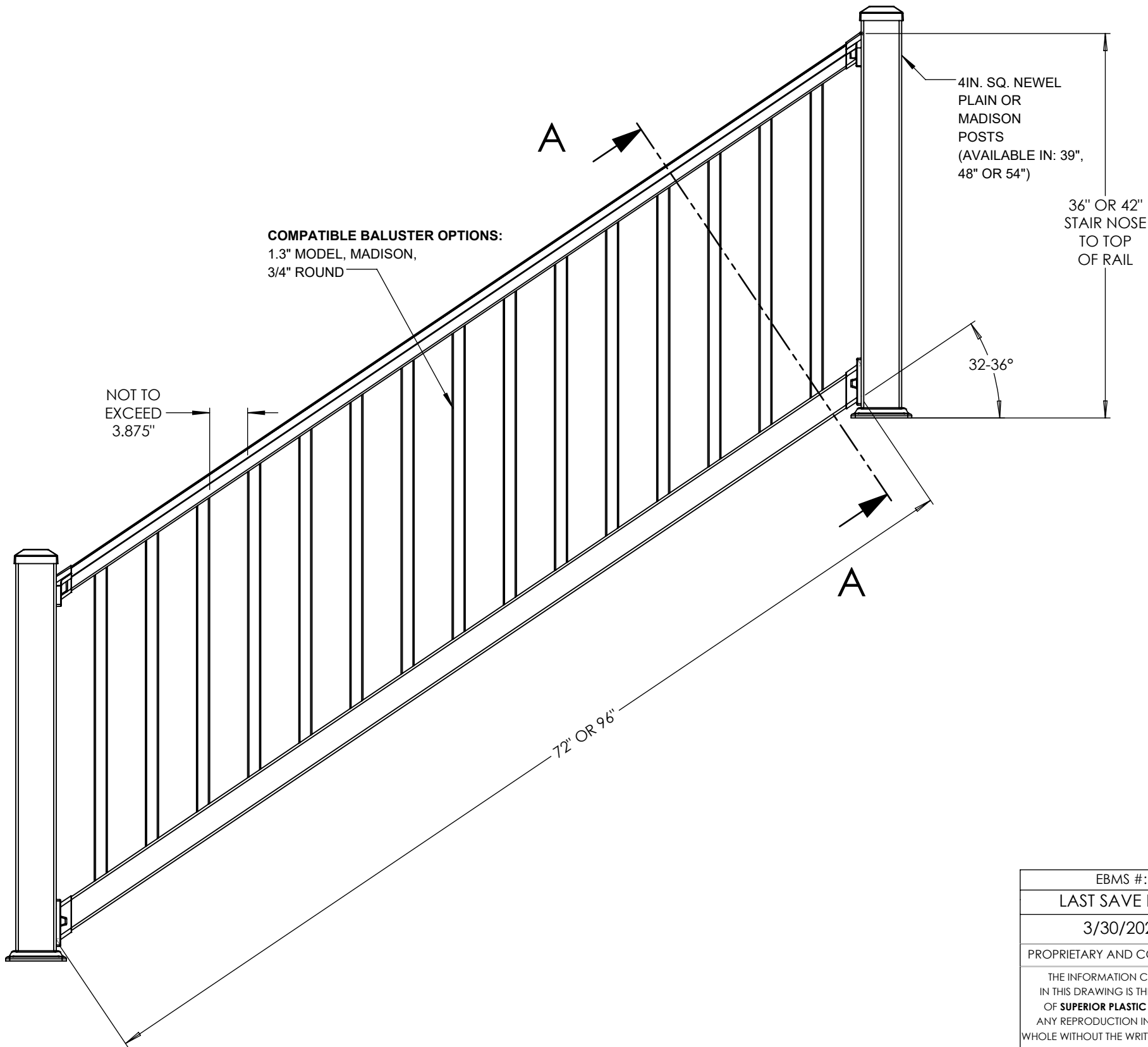
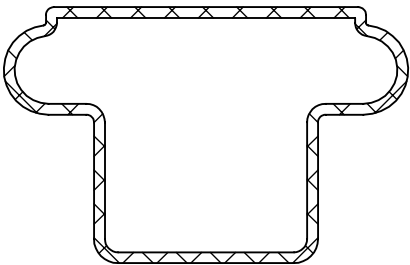

DETAIL D  
SCALE 1 : 1.5

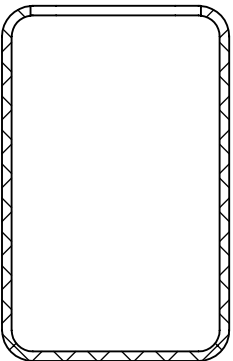

DETAIL E  
SCALE 1 : 1.5

EBMS #:	MODELED BY	NAME	DATE	Superior Plastic Products Inc. 260 Jalyn Dr. New Holland, Pa 17557		
LAST SAVE DATE	DRAWN BY	J.Coon	12/8/2022			
3/30/2023	APPROVED BY	J.Coon	12/8/2022	TITLE: 200 SERIES STAIR RAIL SECTION		
PROPRIETARY AND CONFIDENTIAL	PROJECTION	UNLESS OTHERWISE SPECIFIED: 1. DIMENSIONS ARE IN INCHES 2. BREAK ALL SHARP EDGES 3. TOLERANCES: FRACTIONAL $\pm 1/64"$ ANGULAR:MACH $\pm 1.0^\circ$ BEND $\pm 1.0^\circ$ TWO PLACE DECIMAL $\pm 0.01"$ THREE PLACE DECIMAL $\pm 0.005"$		SIZE	DWG. NO.	REV
THE INFORMATION CONTAINED IN THIS DRAWING IS THE PROPERTY OF <b>SUPERIOR PLASTIC PRODUCTS</b> . ANY REPRODUCTION IN PART OR IN WHOLE WITHOUT THE WRITTEN PERMISSION OF <b>SUPERIOR PLASTIC PRODUCTS</b> IS PROHIBITED.	DO NOT SCALE DRAWING			<b>B</b>	139198	01
	FINISH	N/A	MATERIAL	SEE BILL OF MATERIALS	SCALE: 1:12	WEIGHT: 23.42 lbs. SHEET 1 OF 1