

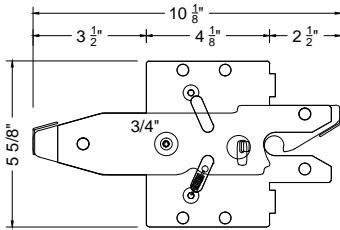

ARCHITECTURAL DRAWING:
GATE HARDWARE FOR TREX
SECLUSIONS AND HORIZONS
FENCING SYSTEMS

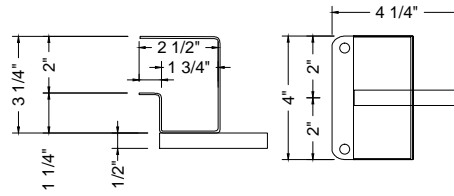

SINGLE GATE LATCH



SINGLE GATE STRIKER

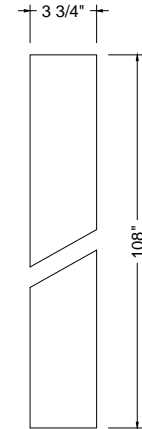
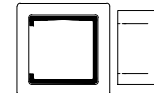

GATE POST STIFFENER
(HINGE SIDE ONLY)

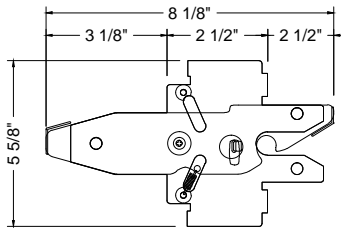

DOUBLE GATE LATCH

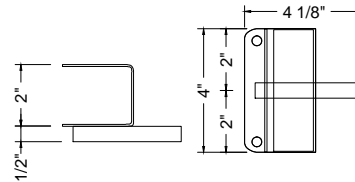

DOUBLE GATE STRIKER

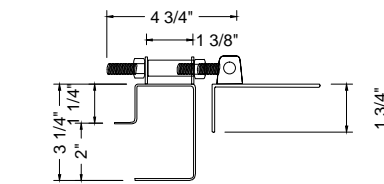

ADJUSTABLE HINGE

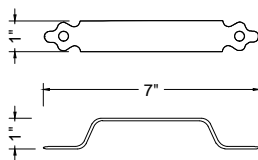
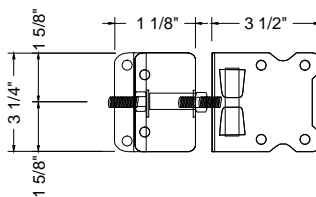

GATE HANDLE

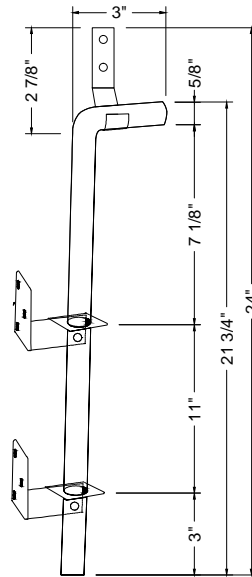

DROP ROD ASSEMBLY

- A: BLACK VINYL COATED STEEL CABLE
- B: CABLE CLAMP (2)
- C: 'S' HOOK
- D: 'D' RINGS (2)
- E: 1" SELF-TAPPING SCREWS (2)
- F: TURNBUCKLE

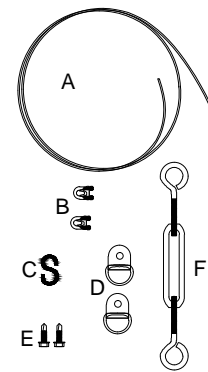

OPTIONAL: ANTI-SAG CABLE

NOTES:

1. INSTALLATION TO BE COMPLETED PER MANUFACTURER'S SPECIFICATION.
2. THIS DRAWING IS PROVIDED FOR PLANNING PURPOSES. REFER TO MANUFACTURER'S INSTALLATIONS FOR CONSTRUCTION DETAILS.
3. REFER TO MANUFACTURER'S WEBSITE FOR PRODUCT INFORMATION.
4. DRAWING NOT TO SCALE.

ALL TREX GATE HARDWARE IS MADE OF STAINLESS STEEL AND IS POWDER-COATED BLACK. SELF-TAPPING SCREWS ARE INCLUDED.

TREX FENCING GATE HARDWARE

160 EXETER DR, WINCHESTER, VA 22603
1-800-BUY-TREX / WWW.TREXFENCING.COM