

LEGEND:

1: EXHAUST  
GAS:  
2: GAS INLET  
3: 0.875 ELECTRICAL

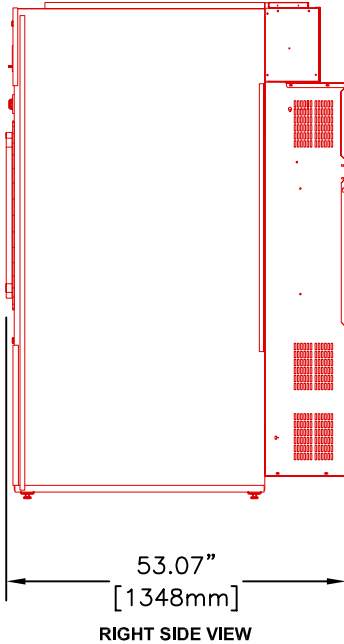
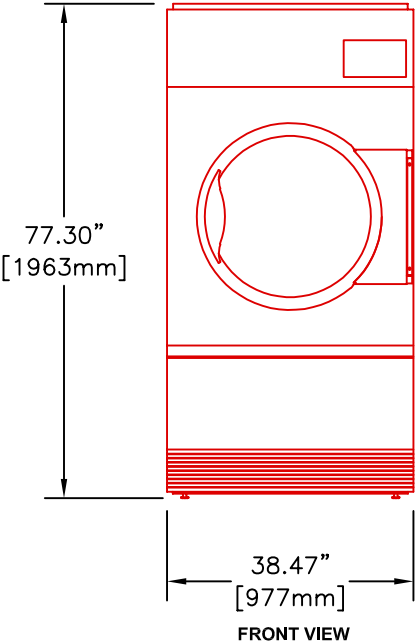
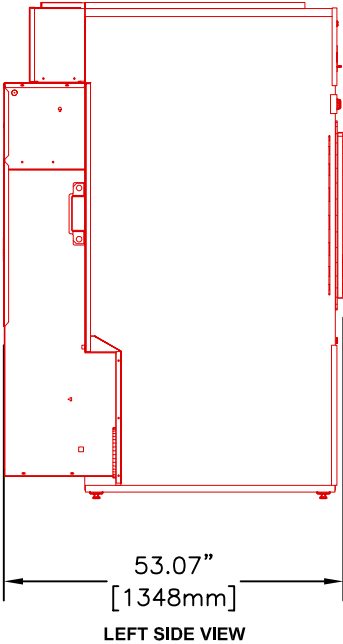
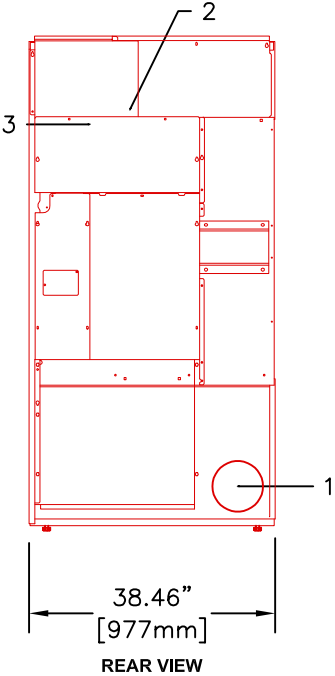
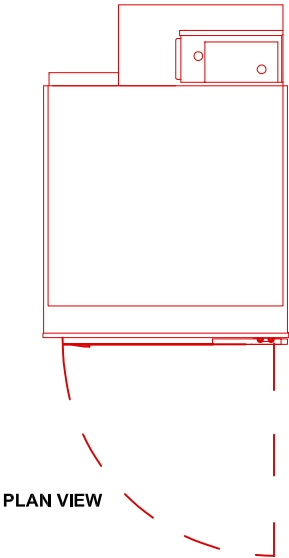

75 LB. TUMBLE DRYER

FAST DRY (UTF75)



Equipment specifications are subject to change without notice. Please use this drawing along with the installation manuals for updated equipment installation requirements.

KRP	CAD BLOCK	23-May-22
Drawn by	Description	Date