

COLUMN DEPTH	BR LOC (CONTIN)
0" THRU 28"	2'-0"
28"+ THRU 42"	3'-0"
42"+ THRU 60"	4'-0"

NOTE: ALL BOLTS TO BE
 1/2" X 1 1/2" A325 (49080)
 TIGHTEN BOLTS TO "SNUG TIGHT"
 CONDITION AS DEFINED BY THE
 AISC/RCSC "SPECIFICATION FOR
 STRUCTURAL JOINTS USING ASTM
 325 OR A490 BOLTS"

FLANGE BRACE
 (FB-) OR (SFB-)

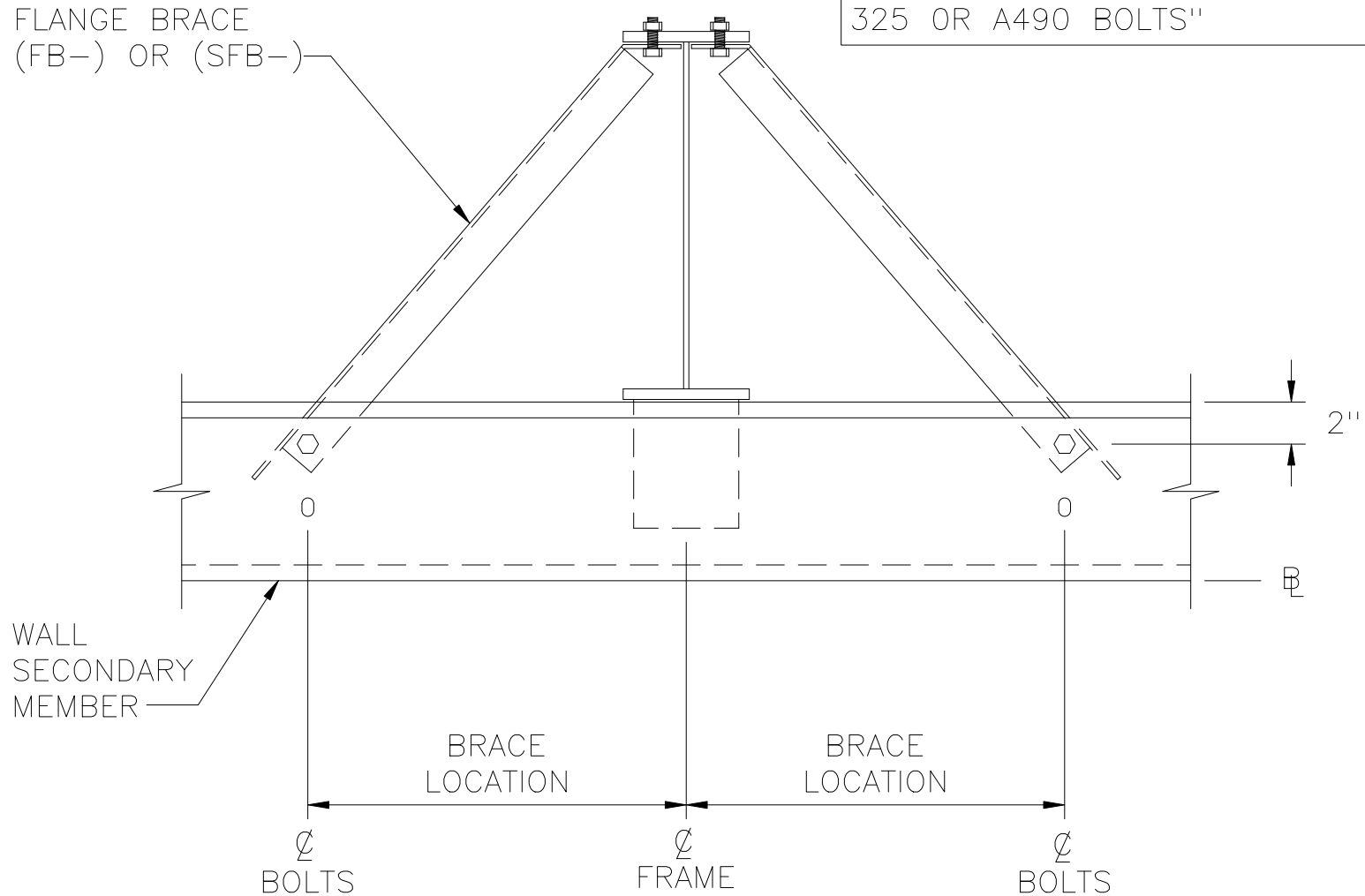

WALL FLANGE BRACING

OUTSET SIDEWALL COL (CONTINUOUS & SIMPLE)

BR07A1V4 R 04/01/2000

BR07A1	