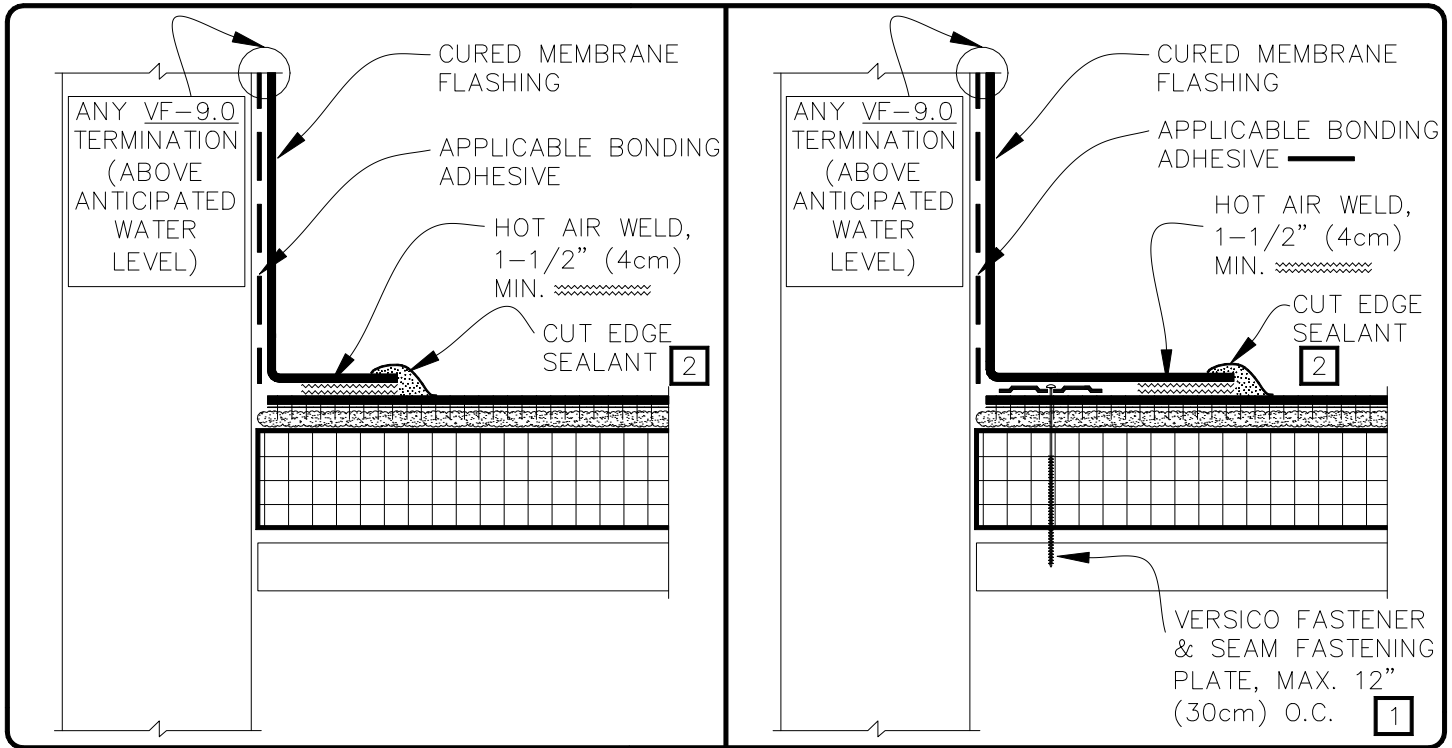

CAUTION

REFER TO DETAIL VF-12.3 WHEN USING AQUA BASE 120 ADHESIVE.

NOTES:

1. MECHANICALLY ATTACHED BASE SECUREMENT IS REQUIRED WHEN ANY ONE OF THE FOLLOWING MAY OCCUR:
 - 1.1. SPECIFIED WARRANTIES GREATER THAN 20-YEARS.
 - 1.2. WARRANTY WIND SPEEDS GREATER THAN 90MPH.
 - 1.3. PROJECTS WITH CONTROL OR EXPANSION JOINTS OR ANTICIPATED BUILDING MOVEMENT.
 - 1.4. WHEN VERSIFLEECE MEMBRANE IS INSTALLED DIRECTLY OVER AN EXISTING SINGLE-PLY ROOF.
2. APPROXIMATELY 1/8" (0.5cm) DIAMETER BEAD OF CUT-EDGE SEALANT IS REQUIRED ON CUT EDGES OF REINFORCED TPO MEMBRANE.
3. WHEN USING 60 OR 80-MIL REINFORCED THERMOPLASTIC MEMBRANE, APPLY A 4-1/2" (11cm) DIAMETER THERMOPLASTIC "T-JOINT" COVER AT ALL FIELD SPLICE INTERSECTIONS.