

NOTES:

1. WHEN MECHANICAL FASTENERS ARE USED TO PENETRATE THE METAL COUNTER-FLASHING, USE EPDM WASHERS, APPLY WATER CUT-OFF MASTIC UNDER THE COUNTER-FLASHING OR CAULK THE FASTENER HEADS.
2. LAP SEALANT IS REQUIRED ON CUT-EDGES OF REINFORCED MEMBRANE.
3. SEAM PLATES AND FASTENERS MAY BE INSTALLED INTO THE STRUCTURAL DECK AND THEN HPX FASTENERS AND POLYMER SEAM PLATES ARE REQUIRED FOR MECHANICALLY-FASTENED ROOFING SYSTEMS OVER STEEL DECKS.
4. MEMBRANE SPLICES SHALL INCORPORATE 6" (15cm) WIDE QA SEAM TAPE FOR PROJECTS WITH 25 AND 30-YEAR WARRANTIES.
5. IF THE VERTICAL SPLICE ON THE CURB FLASHING IS NOT LOCATED AT THE CORNER, USE DETAIL VGC-2.3 FOR EPDM MEMBRANE SPLICES AT ANGLE CHANGES.

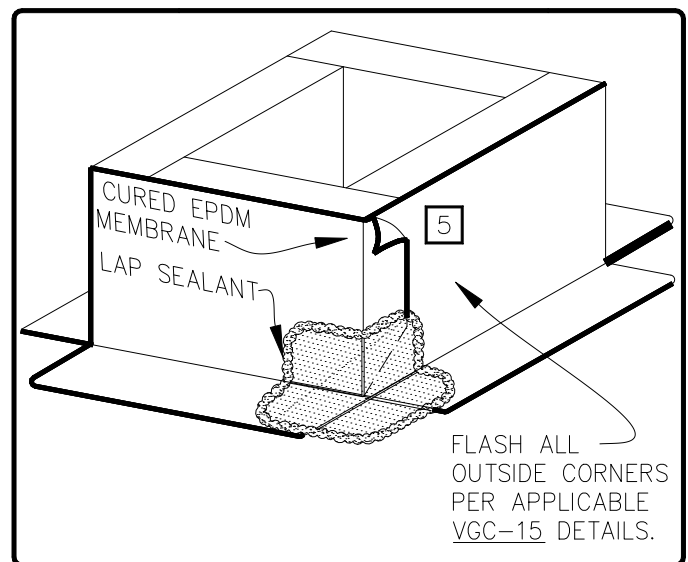
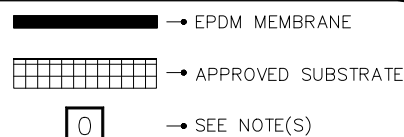

MAXIMUM WARRANTY: 30 YEARS

CURB FLASHING — EPDM
MEMBRANETHERMOSET
ROOFING SYSTEM
VGC-5.1