

CAUTION FOR PROJECTS WITH 25 & 30-YEAR WARRANTIES OR WHEN USING 90-MIL MEMBRANE, REFER TO DETAIL VGC-15.4B FOR REQUIRED FLASHING ENHANCEMENTS.

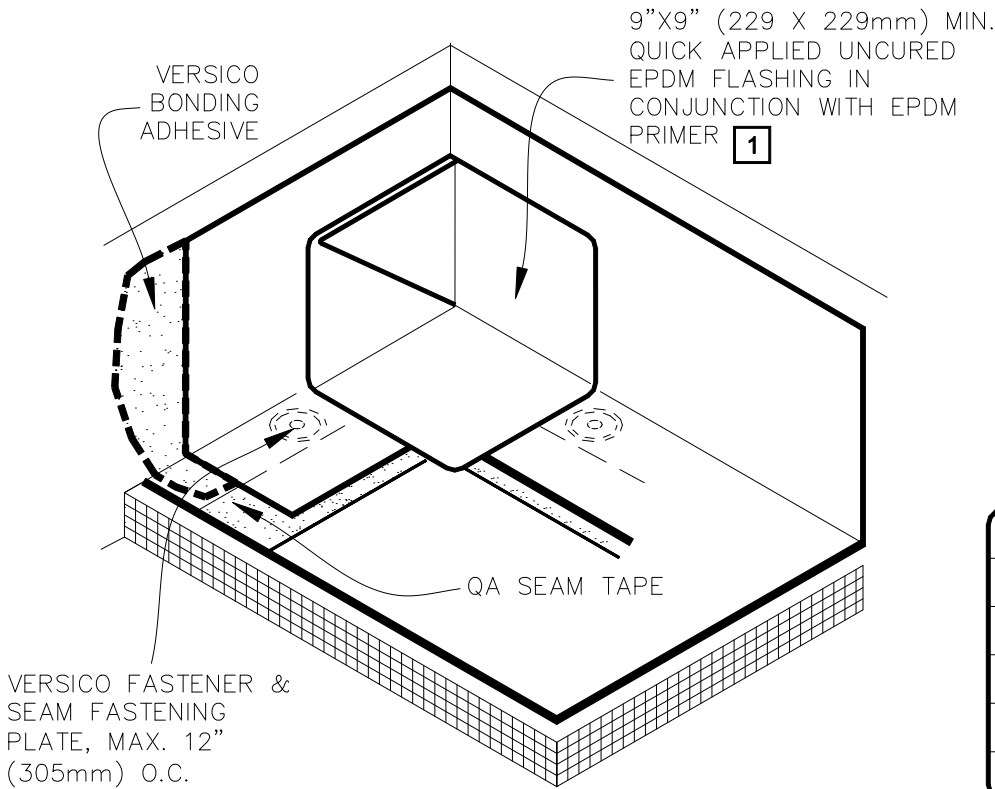

DIMENSIONS		mm	
(A)	6"	152	TO
	9"	229	
(B)	1/8"	3	MIN.
	1"	25	MAX.
(C)	3"	76	MIN.

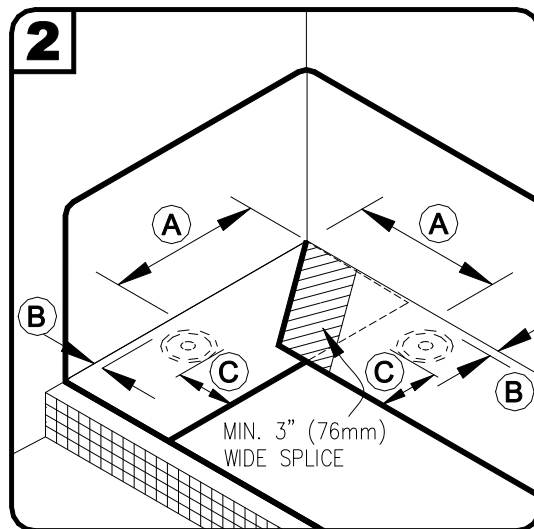
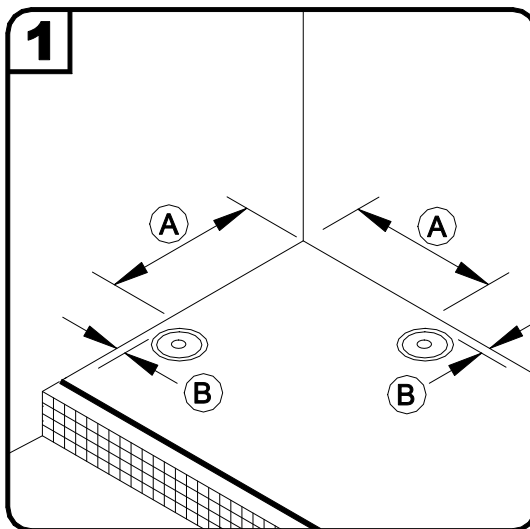

NOTES:

1. APPLY EPDM PRIMER TO THE MEMBRANE SURFACES PRIOR TO INSTALLING QUICK APPLIED FLASHING.
2. IN COLDER TEMPERATURES, A HEAT GUN MUST BE USED WHEN FORMING QUICK APPLIED UNCURED EPDM FLASHING.



INSIDE CORNER WITH SEPARATE EPDM WALL FLASHING

→ EPDM MEMBRANE
 → APPROVED SUBSTRATE
0 → SEE NOTE(S)

THERMOSET ROOFING SYSTEM

VGC-15.4A