

CAUTION

DETAIL NOT FOR USE ON 25 AND 30-YEAR WARRANTY PROJECTS. ACCEPTABLE FLASHING SHALL CONFORM TO DETAILS VGC-5.1 OR VGC-5.2.

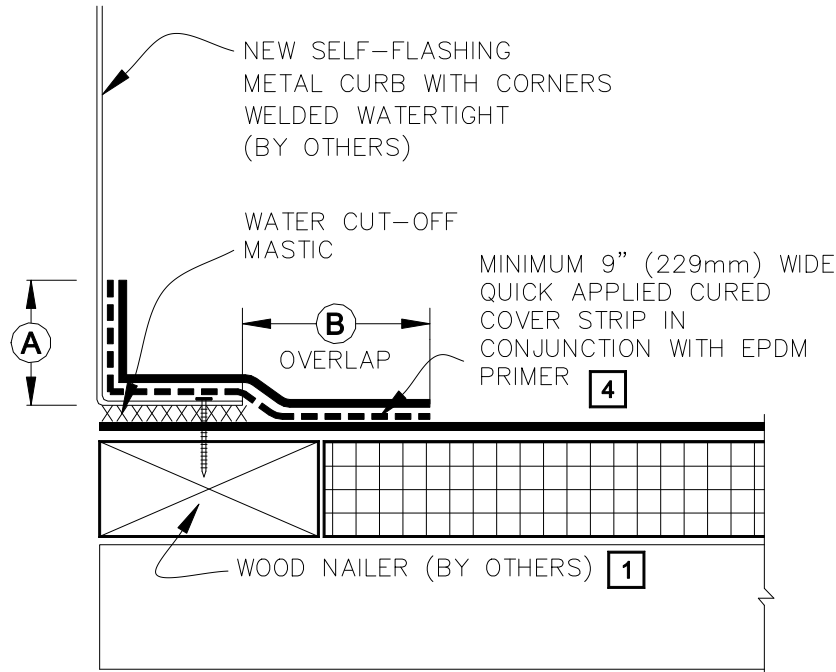



DIMENSIONS		mm	
(A)	2"	51	MIN.
(B)	3"	76	APPROX.

NOTES:

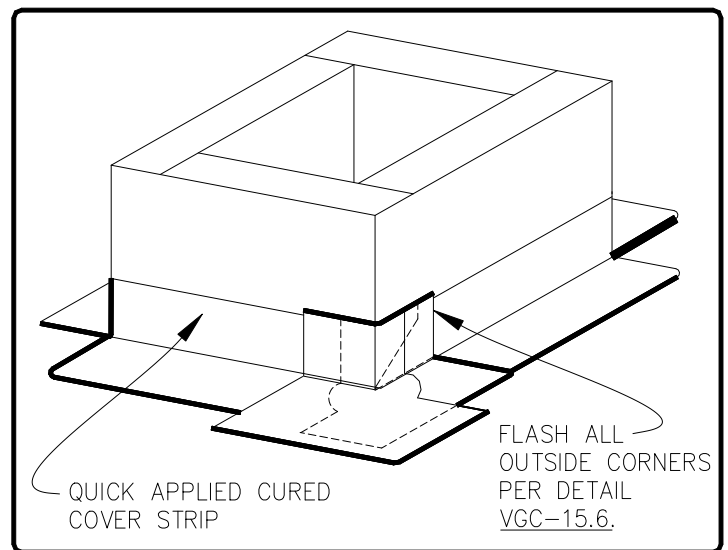
1. WOOD NAILER MUST EXTEND PAST TOTAL WIDTH OF METAL CURB DECK FLANGE.
2. CONSULT THE RESPECTIVE MANUFACTURER OF THE SELF-FLASHING METAL CURB FOR PROPER SECUREMENT.
3. WATER CUT-OFF MASTIC MUST BE HELD UNDER CONSTANT COMPRESSION.
4. 7"X9" (178mm X 229mm) QUICK APPLIED CORNERS CANNOT BE INSTALLED ON THIS DETAIL DUE TO INCOMPLETE COVERAGE OF THE METAL FLANGE AT CORNERS. REFER TO DETAIL VGC-15.6.

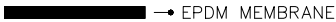

NEW SELF-FLASHING METAL CURB

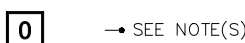
 → EPDM MEMBRANE
 → APPROVED SUBSTRATE
 → SEE NOTE(S)

THERMOSET ROOFING SYSTEM

VGC-5.3