

CAUTION WHEN A PRE-MOLDED PIPE SEAL IS NOT FEASIBLE, PROJECTS WITH 25 & 30-YEAR WARRANTIES REQUIRE ALL ROUND PIPE PENETRATIONS TO BE DOUBLE WRAPPED WITH TWO LAYERS OF QUICK APPLIED UNCURED EPDM FLASHING, TERMINATED WITH A STAINLESS STEEL CLAMPING RING & SEALED WITH CONTINUOUS LAP SEALANT (AS SHOWN).

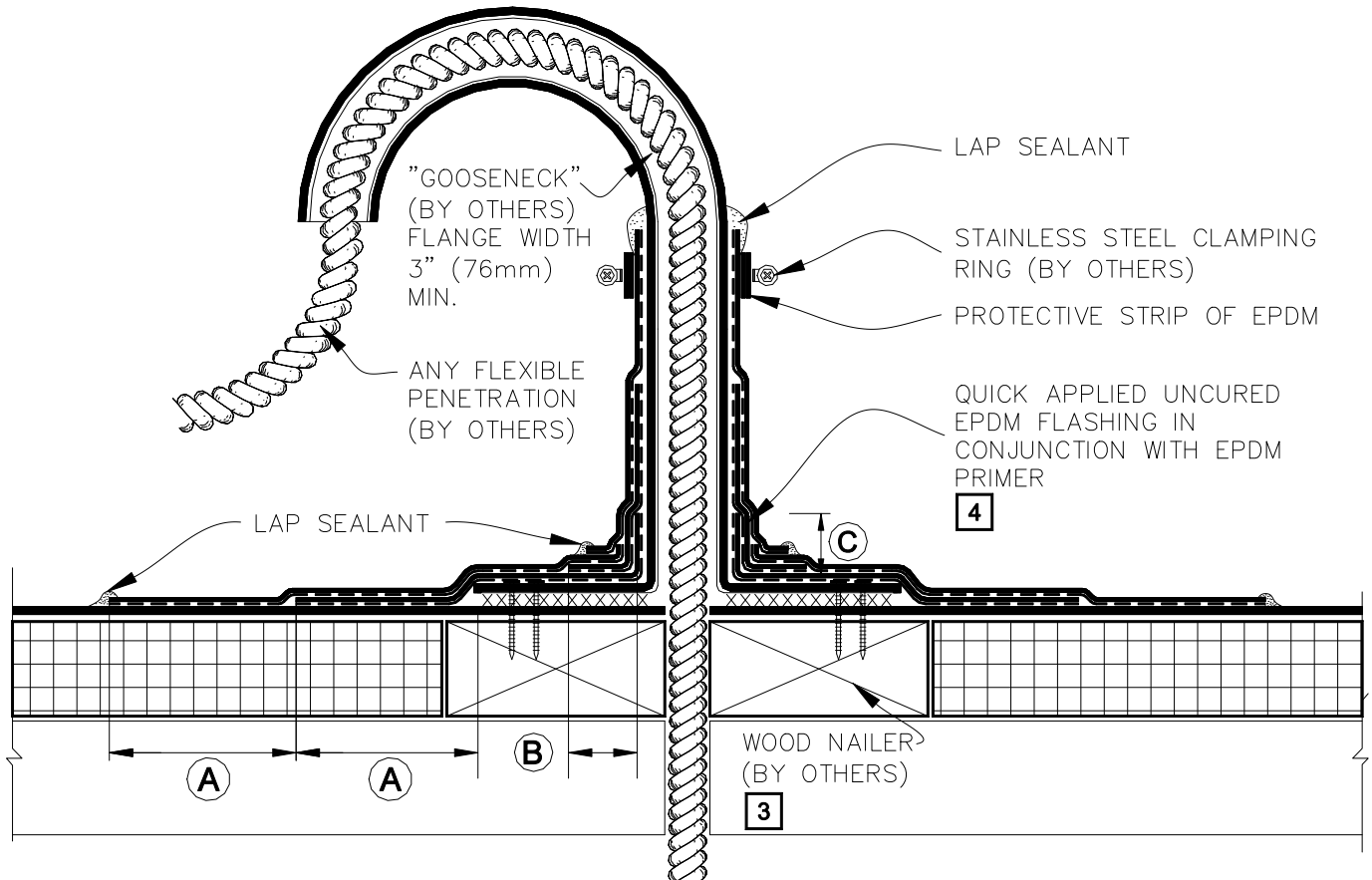

DIMENSIONS		mm	
A	3"	76	MIN.
B	1"	25	MIN.
C	1/2"	13	MIN.

NOTES:

1. REMOVE ALL LEAD AND OTHER FLASHING BEFORE INSTALLING FIELD-FABRICATED PIPE SEAL.
2. TEMPERATURE OF PENETRATION MUST NOT EXCEED 180°F (82°C).
3. WOOD NAILERS MUST EXTEND PAST TOTAL WIDTH OF METAL FLANGE.
4. EPDM PRIMER MUST BE APPLIED TO THE MATING SURFACES PRIOR TO APPLYING QUICK APPLIED UNCURED EPDM FLASHING.
5. IN COLDER TEMPERATURES, A HEAT GUN MUST BE USED WHEN FORMING QUICK APPLIED UNCURED EPDM FLASHING.



FLEXIBLE PENETRATION

→ EPDM MEMBRANE
 → APPROVED SUBSTRATE
 → SEE NOTE(S)

THERMOSET ROOFING SYSTEM

VGC-8.3