

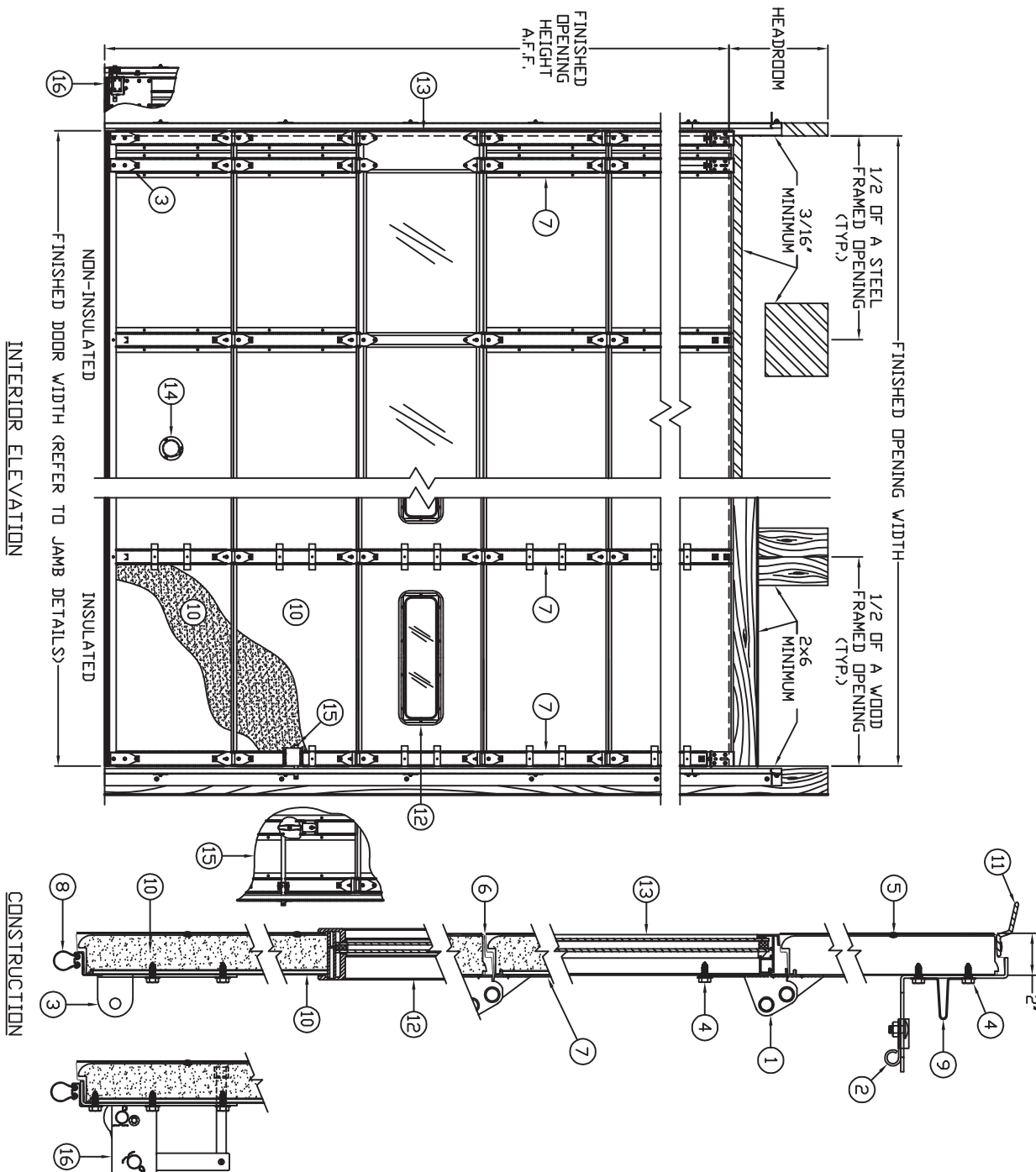

MODELS 220 & 216 (FLUSH EXTERIOR) STEEL OVERHEAD DOORS

PROJECT: _____ CONTRACTOR: _____ ARCHITECT: _____ DOOR DISTRIBUTOR: _____

FRAMING NOTE: WAYNE-DALTON CORP. DESIGN ENGINEERS EACH COMMERCIAL SECTIONAL OVERHEAD GARAGE DOOR FOR INDIVIDUAL APPLICATIONS BASED ON PRODUCT & OPTIONS REQUIRED. ONE, TWO OR FOUR SPRING TORSION ASSEMBLIES ARE TYPICALLY SUPPLIED AS STANDARD. DUAL TORSION SHAFT ASSEMBLIES ARE SUPPLIED WHEN REQUIRED. WHEN IT IS TIME TO PREPARE THE OPENINGS FOR INSTALLATION OF A WAYNE-DALTON PRODUCT, CONTACT OUR CUSTOMER SERVICE REPRESENTATIVES FOR MOUNTING PAD LOCATIONS.



STANDARD FEATURES

1. GRADUATED HOT-DIPPED GALVANIZED STEEL END HINGES (14 GA. MINIMUM).
2. ADJUSTABLE HOT-DIPPED GALVANIZED STEEL TOP BRACKETS.
3. HOT-DIPPED GALVANIZED STEEL ROLLER CARRIERS.
4. (4) 1/4-20 TEK SCREWS PER HINGE & TOP BRACKET.
5. EXTERIOR OF ROLL-FORMED HOT-DIPPED GALVANIZED ZINC COATED SMOOTH STEEL. PRE-PAINTED PRIOR TO ROLL-FORMING (9 MIL. WHITE POLYESTER EXTERIOR, 65 MIL. POLYESTER INTERIOR).
6. MODEL 220 20 GA. WITH FLUSH EXTERIOR.
7. MODEL 216 16 GA. FLUSH EXTERIOR.
8. SHIPLAP MEETING RAILS.
9. OPTIONAL EPDM RUBBER JOINT SEAL.
10. "HAT"-SHAPED HOT-DIPPED GALVANIZED 20 GA. STEEL CENTER AND "BOX"-SHAPED GALVANIZED END STILES SECURED TO ROLL-FORMED PANELS WITH SEMI-TUBULAR RIVETS.
11. -220 SINGLE END HARDWARE (COVER 16'-2" WIDE, -216 DOUBLE END HARDWARE (COVER 14'-2" WIDE).
12. -216 DOUBLE END HARDWARE (COVER 14'-2" WIDE).
13. 1/4 GA. STILES STANDARD MODELS 220 FLUSH & 216 "BULB-SHAPED" BOTTOM ASTRAGAL.
14. EXTERNALLY ATTACHED STRUTS AS REQUIRED.

FREQUENTLY SELECTED OPTIONS

10. 1-9/16" LAID-IN-PLACE INSULATION & BACK-UP:
 - POLYSTYRENE (667 MATERIAL "R"-VALUE)
 - POLYURETHANE (100 MATERIAL "R"-VALUE)
 - WHITE STEEL BACK-UP PANELS:
 - EMBOSSED SMOOTH 24 GA.
 - SMOOTH 20 GA.
11. EPDM RUBBER TOP SECTION HEAD SEAL
12. 24x6 LITES:
 - NON-INSULATED DOORS:
 - 1/8" DSB GLASS 1/8" TEMPERED GLASS
 - ACRYLIC (PLEXIGLASS) 1/8" 1/4"
 - POLYCARBONATE (LEXAN) 1/8" 1/4"
 - 1/4" POLISHED WIRE GLASS
 - 1/4" POLISHED WIRE GLASS
 - INSULATED DOORS (HIGH-IMPACT POLYMER FRAMES):
 - 1/2" DOUBLE INSULATED SSB THERMOLITE
 - 1/4" ACRYLIC (PLEXIGLASS)
 - 1/4" POLYCARBONATE (LEXAN)
 - 1/4" POLISHED WIRE GLASS
 - 1/2" DOUBLE INSULATED TEMPERED THERMOLITE

No. SECTIONS GLAZED

13. ALUMINUM FULL VIEW SECTION: WHITE BROWN

14. No. LITES PER SECTION
- 1/8" DSB
 - ACRYLIC (PLEXIGLASS) 1/8" 1/4"
 - POLYCARBONATE (LEXAN) 1/8" 1/4"
 - TEMPERED GLASS 1/8" 1/4"
 - 1/4" POLISHED WIRE GLASS
 - 1/4" PLATE GLASS
 - 1/2" DOUBLE INSULATED (SSB GLASS)
 - 1/2" DOUBLE INSULATED (TEMPERED GLASS)

No. FULL VIEW SECTIONS

14. 3" EXHAUST PORT (CENTERED BOTTOM SECTION).
15. OMIT LOCKING (INSIDE SIDE LOCK STANDARD)
16. STANDARD SIZE RIM CYLINDER SHORT LOCK BAR (NOT AVAILABLE IN ALUMINUM FULL VIEW).
16. CABLE FAILURE DEVICE.