

GEARBOSS SHELVING LAYOUT SUGGESTIONS

EXAMPLE ELEVATION VIEWS

GENERAL NOTES

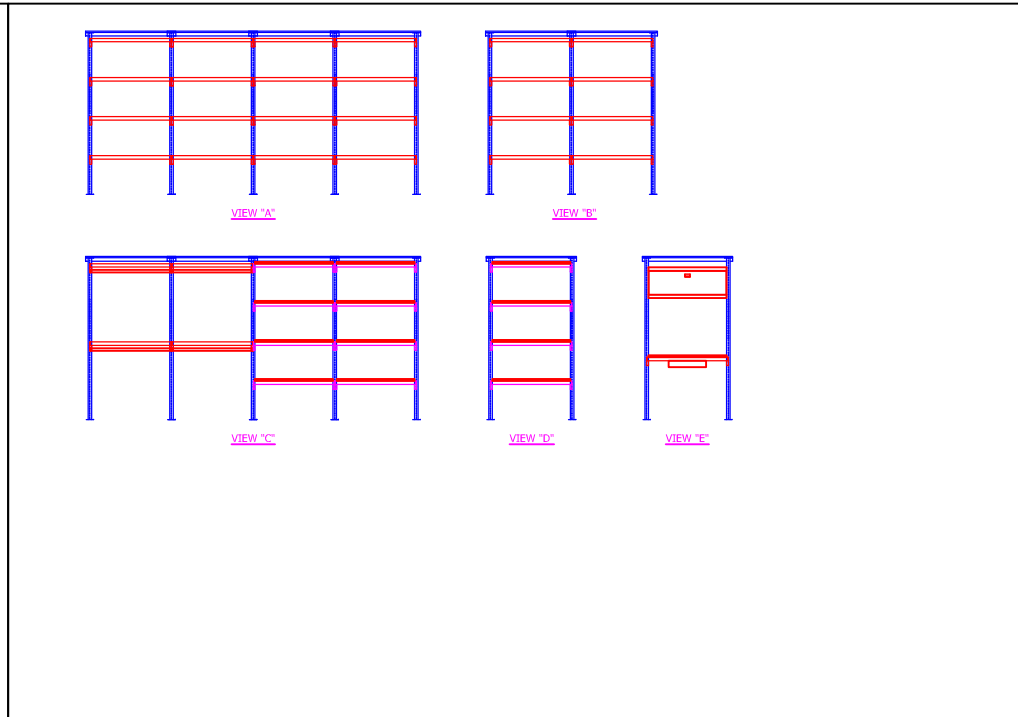
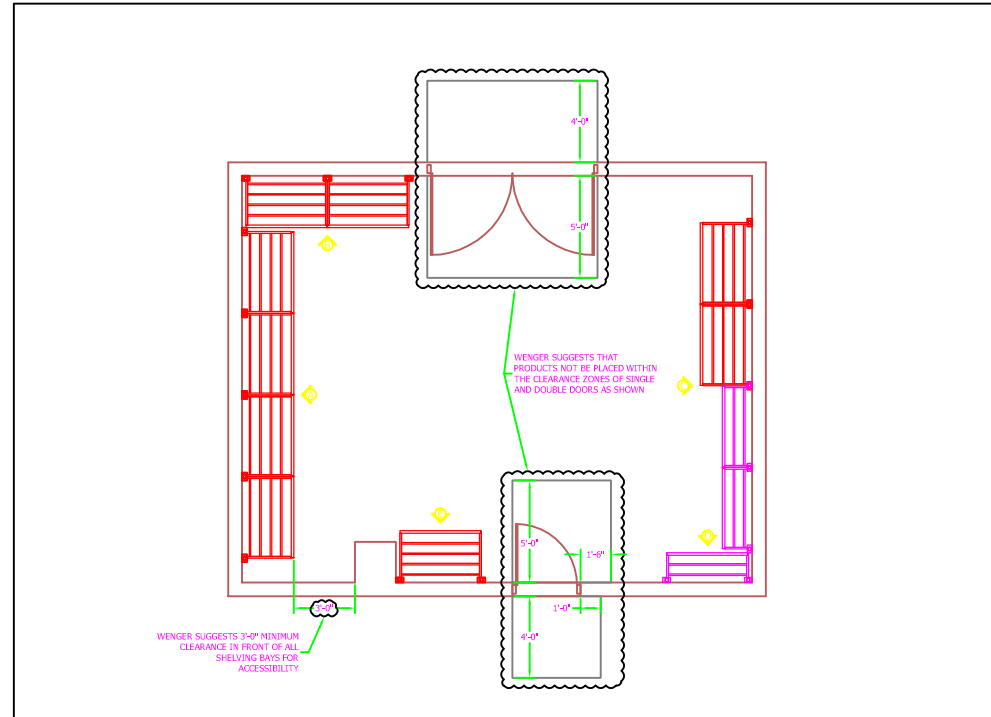

- GEARBOSS SHELVING NOTES:**
1. VERIFICATION OF BUILDING DIMENSIONS TO BE CONFIRMED BY GENERAL CONTRACTOR PRIOR TO CONSTRUCTION.
 2. INSTALL GEARBOSS SHELVING UNITS PER INSTALLATION MANUAL.

17.5" DEEP SHELF & ACCESSORIES

30.5" DEEP SHELF & ACCESSORIES

LOCKBOX

STARTER BAY

ADD-ON BAY

PLAN VIEW

NOTES:
1. SELECT THE BLOCK OF THE DEEPEST SHELF THE BAY WILL CONTAIN, THEN USE THE STRETCH PARAMETERS (BLUE ARROW) TO SET THE BAY WIDTH (STANDARD BAY WIDTH IS 48"). USE AS MANY 48" WIDE STANDARD BAYS AS POSSIBLE AND ONLY USE NON-STANDARD WIDTH BAYS WHEN NECESSARY. THIS WILL PROVIDE THE MOST FLEXIBLE AND COST EFFECTIVE SOLUTION.

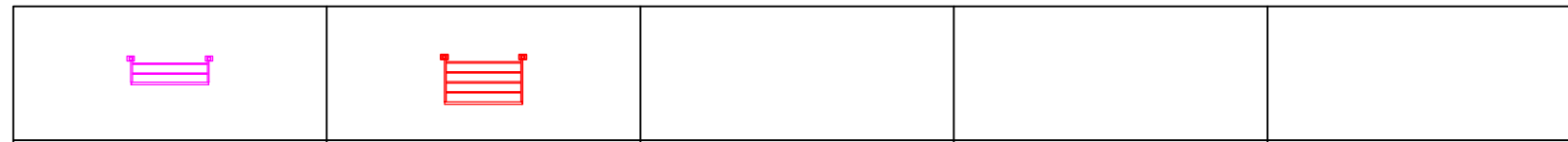

ELEVATION VIEW

GENERAL:
1. THE ELEVATION VIEW MUST BE CREATED USING MULTIPLE BLOCKS.
2. THE STANDARD BAY WIDTH IS 48" AND THE STANDARD BAY HEIGHT IS 96". BAY WIDTHS ARE AVAILABLE FROM 2" WIDE IN 1/2" INCREMENTS AND 6" TALL IN 1" INCREMENTS.
3. USE AS MANY 48" WIDE BAYS AS POSSIBLE AND ONLY USE NON-STANDARD WIDTH BAYS WHEN NECESSARY. THIS WILL PROVIDE THE MOST FLEXIBLE AND COST EFFECTIVE SOLUTION.
4. BEGIN WITH ONE STARTER BAY AT THE FAR LEFT OF EACH BANK, THEN USE ADD-ON BAYS TO COMPLETE THE BANK.
5. ALL BAYS WITHIN A BANK MUST BE THE SAME HEIGHT.

STARTER & ADD-ON BAYS:
1. SELECT THE STARTER BAY OR ADD-ON BAY BLOCK TO ACCESS THE (2) STRETCH PARAMETERS (BLUE ARROWS). THE LOWER RIGHT ARROW CONTROLS THE BAY WIDTH AND THE UPPER LEFT ARROW CONTROLS THE BAY HEIGHT.
2. WHEN PLACING AN ADD-ON BAY, USE THE GRIP POINT (BLUE SQUARE) AND ALIGN IT WITH THE RIGHT FOOT OF THE PREVIOUS BAY.

SHELVES & ACCESSORIES:
1. SELECT THE BLOCK OF THE DESIRED DEPTH SHELF, THEN MOVE IT INTO PLACE USING THE GRIP POINT (BLUE SQUARE). THE GRIP POINT IS TO BE PLACED IN THE CENTER OF AN UPRIGHT TUBE HOLE ON THE LEFT SIDE OF THE BAY.
2. USE THE VISIBILITY PARAMETER (BLUE ARROW IN CENTER) TO ACCESS THE SHELF ACCESSORIES AS REQUIRED.
3. PLEASE NOTE, A 30.5" DEEP SHELF WITH WORK SURFACE AND DRAWER CAN ONLY BE USED ON BAYS 24" WIDE OR GREATER.
4. IF THE SHELF IS BEING ADDED TO A NON-STANDARD WIDTH BAY, EXPLODE THE BLOCK WHICH WILL EXPOSE LOWER-LEVEL BLOCK(S) WITH STRETCH PARAMETER(S) (BLUE ARROWS) ON RIGHT SIDE.
5. USE THE STRETCH PARAMETER(S) TO ADJUST THE BLOCK(S) TO THE NECESSARY WIDTH. THESE STRETCH PARAMETER ARROWS SHOULD ALIGN WITH THE CENTER OF THE UPRIGHT TUBE HOLES ON THE RIGHT SIDE OF THE BAY.

LOCKBOX:
1. SELECT THE LOCKBOX BLOCK, THEN MOVE IT INTO PLACE USING THE GRIP POINT (BLUE SQUARE). THE GRIP POINT WILL BE PLACED IN THE CENTER OF AN UPRIGHT TUBE HOLE ON THE LEFT SIDE OF THE BAY.
2. PLEASE NOTE, A LOCKBOX CAN ONLY BE INSTALLED ON A 48" WIDE BAY.

