

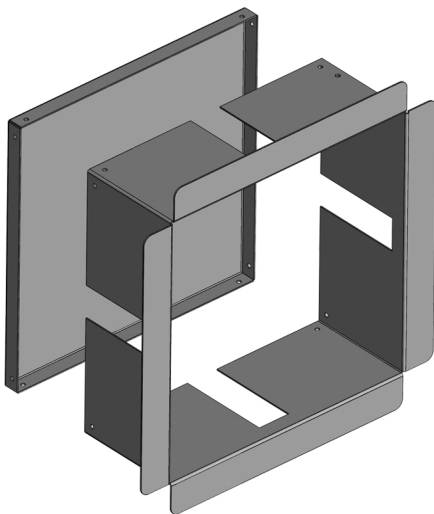

FireShieldLV.com • (702)622-9385

Barri-Box

Barri-Box solves the existing problem for the protection of the membrane penetrations created in a fire rated wall by shower valves. This is perhaps the most overlooked firestop required item due to the complexities of a moving valve, numerous supply lines, and most times a non-metallic escutcheon plate. Barri-Box can be inserted into a wall for new construction, or slipped over existing pipes in a retrofit application.

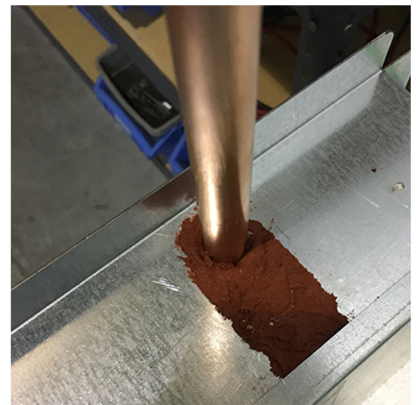
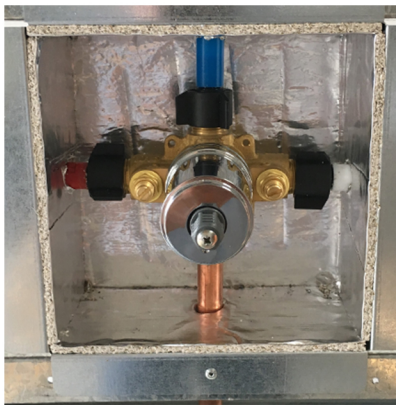

- UL tested and listed, W-L-7249, for shower valve penetrations with code required equal "T" rating
- Non-metallic and metallic escutcheon plates
- Metal and wood stud framing
- Minimum 2-1/2 inch shaft wall included
- Tested in back to back configurations
- Barri-Box constructed of galvanized metal with separate back piece to allow for new construction and retrofit applications
- Slots in the box allow for running supply lines through the mat material
- Standard sizes: 7x7, 7x8, 8x8, and 10x10 in 2.75 depth. Custom sizes and depths are available
- Patent Pending. Made in the United States of America