

FLEXIBLE GLAZING SYSTEM

SI5200FGS • SI5250FGS • SI5300FGS

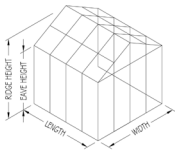

SI5000 FGS series thermally enhanced aluminum glazing system can be utilized in commercial and residential applications. This veneer glazing system can be fastened to almost any capable sub-structure for a minimized profile depth. This system can also be used for greenhouses, skylights, canopies, curtain walls, and other structures.



Straight Eave
Double Pitch

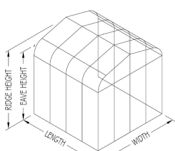

Curved Eave
Double Pitch

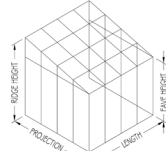

Straight Eave
Lean to

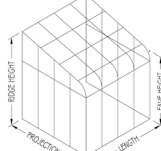

Curved Eave
Lean to

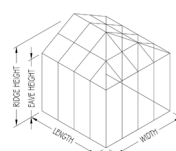

Hip End

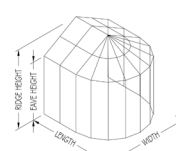

8 Sided
Conservatory

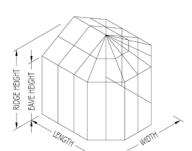

Conservatory
Nose

FEATURES

- 2", 2.5", 3" face widths
- Thermally enhanced aluminum profiles
- Overlapping construction creates positive drainage within profiles
- Glazing infills from $\frac{3}{16}$ " to $1\frac{1}{8}$ "; thicker glass options depending upon engineering
- Standard Finishes
 - Duracron: Hartford Green, Bronze, Black, Natural Clay, White, Sandstone
- LEED friendly system including recycled content
- Designed and manufactured in the U.S.A.
- System requires capable substructure for fastening

OPTIONS

- Large missile impact tested
- Cover cap options
- Custom aluminum finishes
 - Class I anodized: Dark Bronze, Clear
 - Powder coat finish: AAMA 2604-05
 - Fluoropolymers: 50% or 70%
 - Wood and metal cladding
- Turn-key solutions for greenhouses, pool enclosures, and sunrooms

Additional configurations available.



SYSTEMS

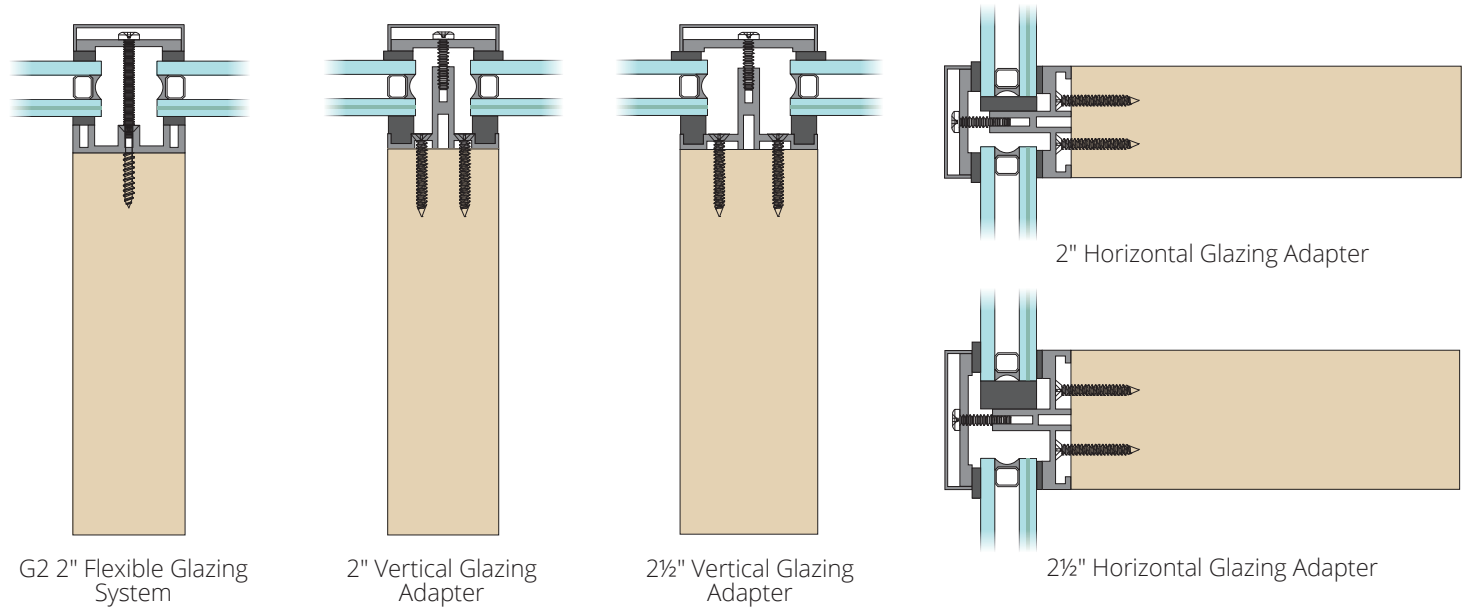

SILLS

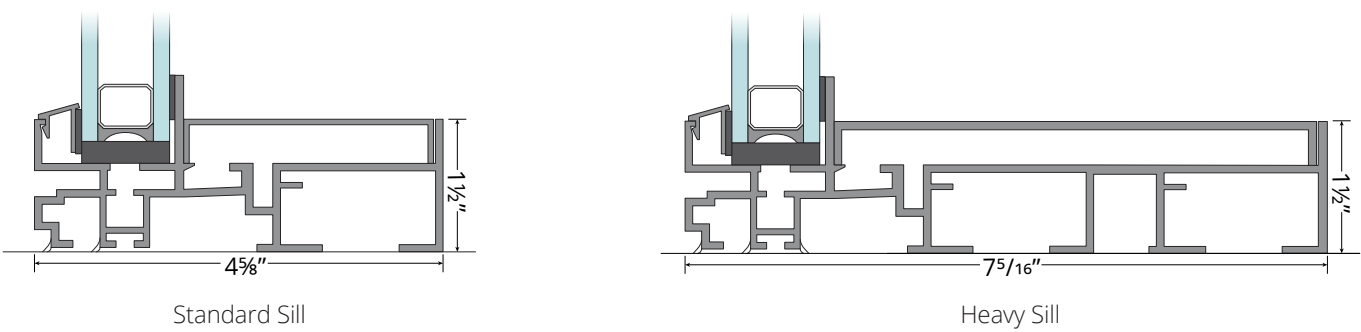

COVER CAPS

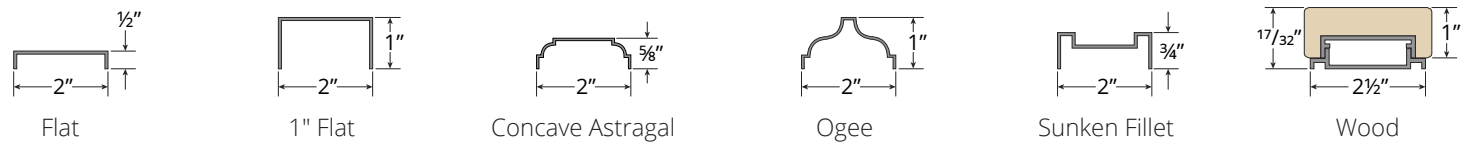

ROUTED EDGES

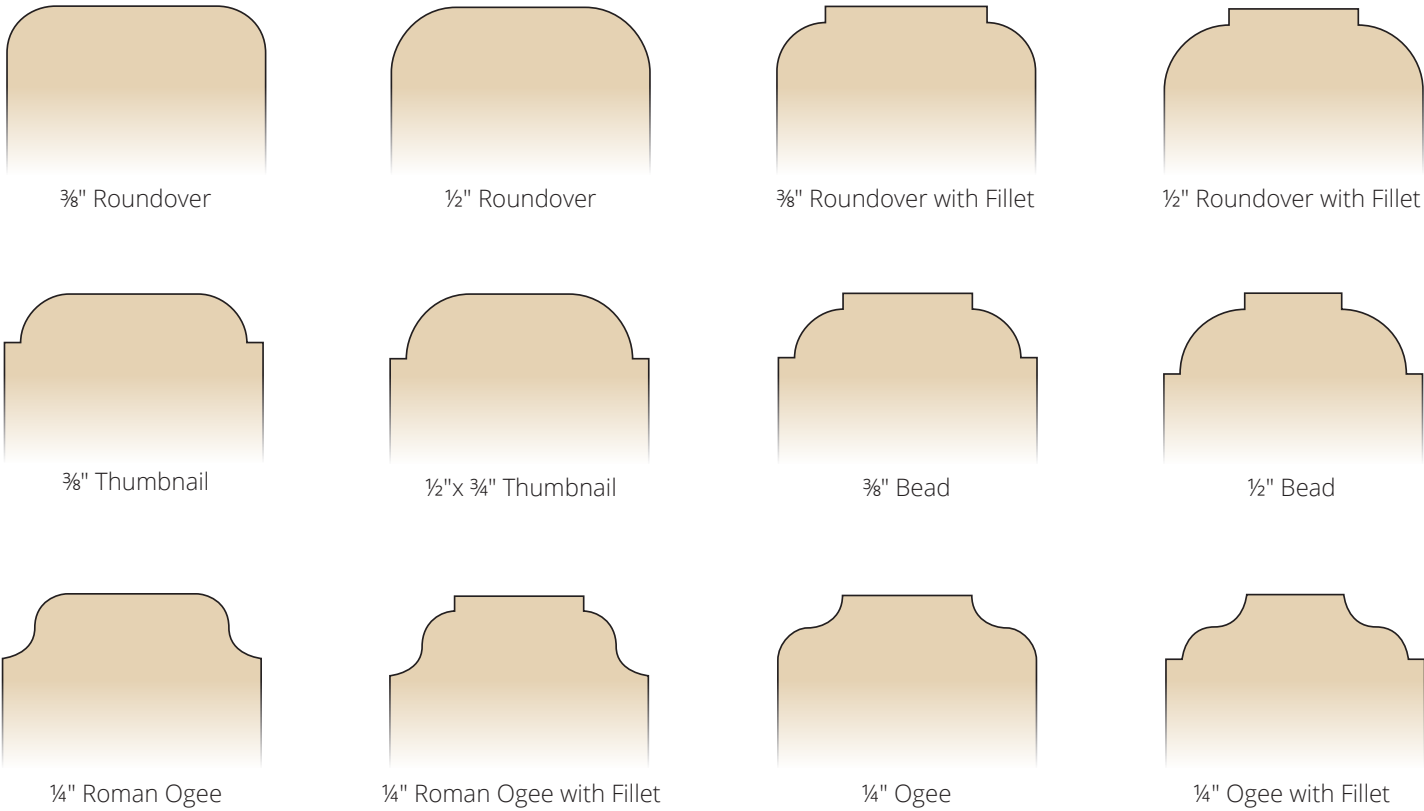

TESTING

2 1/2" Wood Curtain Wall – Air, Water and Structural Testing

Curtain Wall Features	Size	Air Infiltration @6.24psf per ASTME283	Water Resistance per ASTM E331/ ASTME547	Uniform Load Deflection* +/-40.0psf	
				Positive	Negative
				Vertical Member: 0.334"	Vertical Member: 0.354"
Wood species: Ash Glulam Glazing: 1" IGU (1/4" tempered over 1/2" air space over 1/4" tempered) Weeps: 5/16" weep holes located 8" from ends	223 1/2" wide x 128 1/2" tall	0.02 CFM/ft²	15psf	Horizontal Member: 0.133"	Horizontal Member: 0.140"

* No glass breakage or permanent damage.

Individual components cannot be certified.
Only complete assemblies can be certified, as manufactured by Solar Innovations®, Inc.

Please be sure to visit our website for additional product information.
solarinnovations.com