



CUSTOM SIZES AVAILABLE!

Stockton Custom Fabrication

877-786-2587

custom@StocktonProducts.com



VHS: Vented Hat Screed

- Custom Sizes Available, Contact Customer Service For Details
- Available With 1/8", 1/4" Vent Holes or No Vent
- Available Curved Upon Request
- Available in Aluminum (A), Copper (C), Galvanized Steel (GS), Bonderized (BN), Galvalume® (GVM), Stainless Steel (SS) or Zinc (Z)

This screed offers ventilation while providing a finished, "flush" reveal look. A decorative "flush" reveal for use in a soffit condition.

Most Common Sizes

X Sizes: 3/8", 1/2", 5/8", 3/4", 7/8", 1" or 1 3/8"

Y Sizes: 3/4", 1", 1 1/2", 2", 2 1/2", 3", 3 1/2", 4" or 4 1/2"

Length: 120"

Materials And Finishes:

Details: stpro.us/MET

Aluminum (A), Copper (C), Galvanized Steel (GS), Bonderized (BN), Galvalume® (GVM), Stainless Steel (SS) or Zinc (Z)

ASTM Codes:

Details: stpro.us/ASTM

653-CS, A1018, A262, A36, A513, A653, A792, A924, B370-12, B-209, B-209, B6/B69, C1047, C1063, C841, ML/SFA 920

Most Common Part Numbers:

VHS012V200 VHS: X=1/2, 1/8 Vent, Y=2, GS, 10'

VHS012V300J VHS: X=1/2, 1/4 Vent, Y=3, GS, 10'

VHS034V200 VHS: X=3/4, 1/8 Vent, Y=2, GS, 10'

VHS034V300J VHS: X=3/4, 1/4 Vent, Y=3, GS, 10'

VHS038V200JA VHS: X=3/8, 1/4 Vent, Y=2, A, 10'

VHS058V200 VHS: X=5/8, 1/8 Vent, Y=2, GS, 10'

VHS078V200J VHS: X=7/8, 1/4 Vent, Y=2, GS, 10'

VHS516V200L VHS: X=5/16, 1/2 Vent, Y=2, GS, 10'

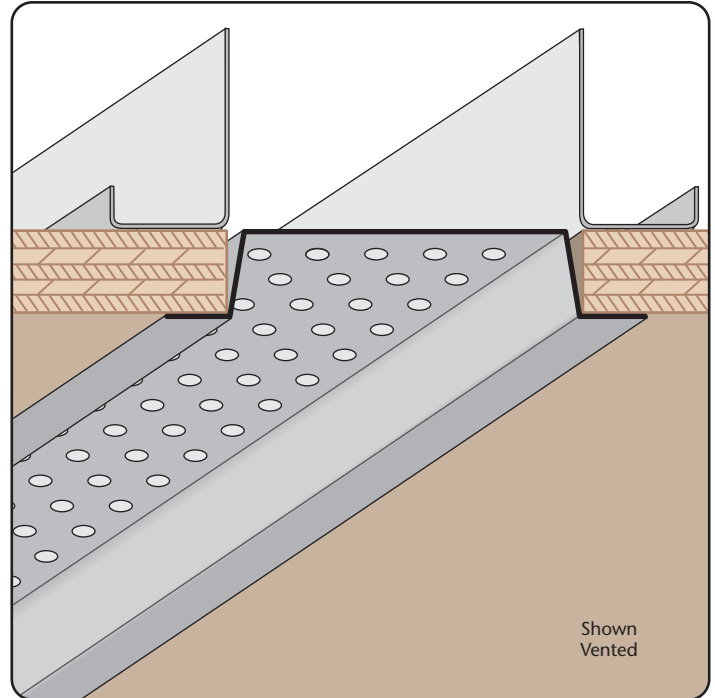

Shown Vented

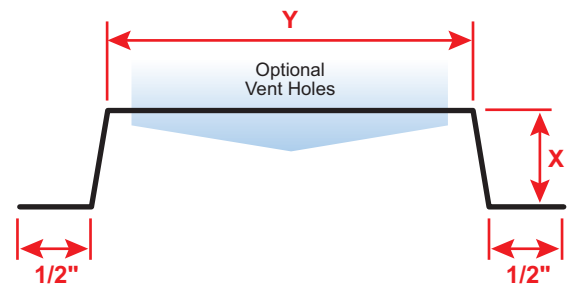

QUOTE

Company: _____
Name: _____
Address: _____
City: _____
State/ZIP: _____
Phone: _____
eMail: _____

QTY: _____
Material/Gauge: _____
X Size: _____
Y Size: _____
Length: _____
Vent Holes: ☐ None ☐ 1/8" ☐ 1/4"

PO Number: _____
Job/Project: _____
Notes: _____

877-786-2587 • StocktonProducts.com



VHS: Vented Hat Screed

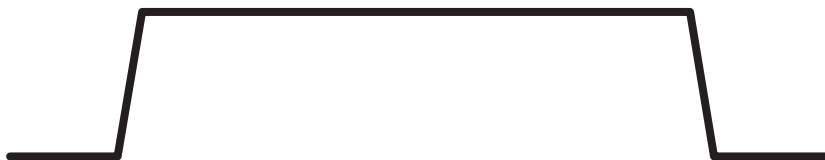
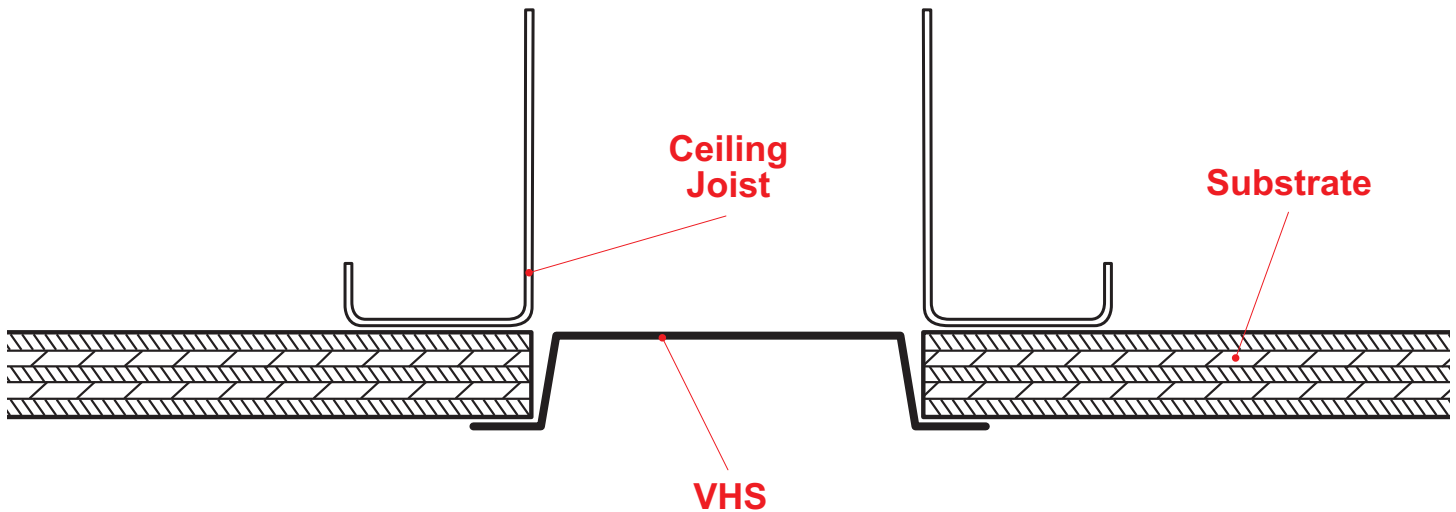

This screed offers ventilation while providing a finished, “flush” reveal look. A decorative “flush” reveal for use in a soffit condition.

Note: This drawing is supplied solely to assist in the selection and application of product manufactured by Stockton Products. This drawing is generic in nature and should not be used in design or construction without an independent evaluation by a qualified Architect or Engineer of Record.

©2023 Stockton Products. All rights reserved worldwide. Product illustrations are for reference only. Rev 041423

CALIFORNIA RESIDENTS: Please review our Prop 65 statement at stpro.us/P65 or visit www.P65Warnings.ca.gov